

**NATIONWIDE**  
INDUSTRIES™



# ORNAMENTAL FENCE HARDWARE AND COMPONENTS

HINGES / LATCHES / CAPS / FINIALS / BRACKETS / ACCESSORIES

[nationwideindustries.com](http://nationwideindustries.com)

# TABLE OF CONTENTS

---

## 3 CORNERSTONE® 2

CORNERSTONE® 2 NON ADJUSTABLE HINGE  
CORNERSTONE® 2 SQUARE POST FULLY ADJUSTABLE HINGE  
CORNERSTONE® 2 HEAVY DUTY

## 4 CORNERSTONE®

CORNERSTONE® SERIES SELF-CLOSING NYLON HINGES  
CORNERSTONE® NON ADJUSTABLE HINGE  
CORNERSTONE® SQUARE POST FULLY ADJUSTABLE HINGE  
CORNERSTONE® MINI VERTICALLY ADJUSTABLE HINGE

## 5 ORNAMENTAL FENCE HINGES

CORNERSTONE® VERTICALLY ADJUSTABLE HINGE  
CORNERSTONE® FULLY ADJUSTABLE HINGE  
SQUARE GATE HINGES - FEMALE  
SQUARE POST HINGES - MALE  
SQUARE COLLARS  
SQUARE FORKS  
4" SELF-CLOSING ALUMINUM HINGE  
5" SELF-CLOSING ALUMINUM HINGE  
5 3/4" SELF-CLOSING ALUMINUM HINGE  
NAUTILUS® CONTROLLED CLOSING GATE HINGE  
NAUTILUS® CONTROLLED CLOSING GATE HINGE  
5 3/4" SELF-CLOSING ALUMINUM HINGE  
4" NON SELF-CLOSING ALUMINUM HINGE  
HORIZONTAL ADJUSTABLE SELF-CLOSING STAINLESS STEEL HINGE

## 8 HEAVY DUTY SEALED BEARING HINGES

## 12 ORNAMENTAL HEAVY DUTY GATE HINGES

HEAVY DUTY NON SELF-CLOSING ALUMINUM HINGE  
HEAVY DUTY BLOCK HINGE FOR ALUMINUM GATE  
HEAVY DUTY STEEL BARREL HINGE  
HEAVY DUTY ESTATE GATE HINGE  
LARGE HEAVY DUTY BALL BEARING HINGE

## 13 ORNAMENTAL FENCE LATCHES

KEYSTONE® SERIES  
TWO-SIDED LOCKABLE LATCH - NYLON  
TWO-SIDED LOCKABLE LATCH - METAL  
ONE-SIDED LOCKABLE LATCH - NYLON  
ONE-SIDED LOCKABLE LATCH - METAL  
KEYLESS LOCK FOR ORNAMENTAL GATES  
KEYSTONE® PANICLATCH™  
THE KEYSTONE® X-EXTERNAL MOUNT LATCH  
SAME KLX LATCH, WITH SLIMLINE DESIGN  
TRIDENT™  
AQUALATCH®  
THE PROTECTOR®  
THE PROTECTOR® JR.  
STAINLESS STEEL GRAVITY LATCH  
ROUND POST ADAPTER FOR CHAIN LINK  
HIDDEN SPRING LATCHES  
ARMORLATCH®  
MANTA® MAGNETIC LATCH  
ORNAMAG® MAGNETIC GATE LATCH  
FLIP LATCH  
FULCRUM LATCH

## 17 ORNAMENTAL FENCE LATCHES & POST CAPS

MAGNETIC SIDE PULL SPL 100 LATCH  
MODERN POST CAP - PRESS FIT  
TRADITIONAL POST CAP - PRESS FIT  
STEEL POST CAPS

## 18 ORNAMENTAL FENCE BALL CAPS

BALL CAPS - PRESS FIT

## 19 ORNAMENTAL FENCE FINIALS

## 21 ORNAMENTAL WALL MOUNT BRACKETS

SWIVEL BALL BRACKET BASES  
SQUARE DUAL FLANGE WALL MOUNT BRACKET 1" X 1"  
SWIVEL BALL BRACKET 1" X 1"  
SINGLE FLANGE WALL MOUNT BRACKET 1" X 1 1/8"  
SWIVEL BALL BRACKET 1" X 1 1/8"  
SINGLE FLANGE WALL MOUNT BRACKET 1" X 1 1/2"  
RECTANGULAR DUAL FLANGE WALL MOUNT BRACKET 1" X 1 1/2"  
SWIVEL BALL BRACKET 1" X 1 1/2"

## 24 ORNAMENTAL WALL MOUNT AND HAND RAIL BRACKETS

SQUARE DUAL FLANGE WALL MOUNT BRACKET 1 5/8" X 1 5/8"  
ADJUSTABLE DUAL FLANGE WALL MOUNT BRACKET 1 5/8" X 1 5/8"  
SWIVEL BALL BRACKET 1 5/8" X 1 5/8"  
STRAIGHT WALL MOUNT BRACKET 1 3/4" X 1 3/4"  
STRAIGHT HAND RAIL BRACKET 1 3/4" X 1 3/4"  
SWIVEL BALL BRACKET 1 3/4" X 1 3/4"

## 25 ORNAMENTAL WALL MOUNT AND RAIL BRACKETS

RESIDENTIAL STRAIGHT WALL BRACKET  
RESIDENTIAL SWIVEL BALL BRACKET  
INDUSTRIAL STRAIGHT WALL BRACKET  
COMMERCIAL STRAIGHT WALL BRACKET  
COMMERCIAL SWIVEL BALL BRACKET  
INDUSTRIAL SWIVEL BALL BRACKET

## 26 ORNAMENTAL WALL MOUNT BRACKETS AND END CAPS

RECTANGULAR DUAL FLANGE RAIL MOUNT BRACKET 1" X 2"  
RECTANGULAR SINGLE FLANGE RAIL MOUNT BRACKET 1" X 2"  
FLAT WALL MOUNT BRACKET 1" X 2"  
FLAT WALL MOUNT BRACKET 2-1/8" X 1-1/8"  
FLAT WALL MOUNT BRACKET 2-1/8" X 1-1/8"  
ROUND SINGLE FLANGE WALL 1" X 1 5/8"  
'V' FLANGE WALL MOUNT BRACKET  
RECTANGULAR DUAL FLANGE WALL  
MUSHROOM SINGLE FLANGE MOUNT BRACKET

## 27 ORNAMENTAL FLOOR MOUNTS AND COVER PLATES

PREMIUM FLOOR MOUNT BRACKETS  
ONE PIECE COVER PLATE  
TWO PIECE COVER PLATE  
TWO PIECE "CORE" COVER PLATE

## 28 KNUCKLES, O-RINGS AND KEYLESS LOCKS

ALUMINUM INDUSTRIAL DOUBLE 'O' RING  
ALUMINUM DECORATIVE SINGLE 'O' RING USE WITH 5/8"  
PICKET SYSTEM (SPECIAL ORDER)  
ALUMINUM DECORATIVE DOUBLE 'O' RING  
3" ALUMINUM RING  
5/8" ALUMINUM QUAD RING  
3-7/8" ALUMINUM RING  
ALUMINUM DECORATIVE SCROLL  
KNUCKLES  
KEYLESS LOCKS

## 29 LOCK BOXES, GATE HANDLES AND BUMPERS, DROP RODS

MORTISE LOCKSET BOX  
DOUBLE HOLE LOCK BOX  
NYLON GATE BUMPER  
NYLON GATE HANDLES  
STAINLESS STEEL GATE HANDLE  
STAINLESS STEEL GATE BUMPER  
HEAVY DUTY STAINLESS STEEL DROP ROD  
STAINLESS STEEL KEY LOCKING DROP RODS  
ARBOR COLLAR

## 30 DROP RODS, GUIDE ROLLERS, HYDRAULIC GATE CLOSERS

ALUMINUM DROP RODS  
COMMERCIAL DROP RODS  
COMMERCIAL PAD LOCKABLE DROP RODS  
COMMERCIAL PAD LOCKABLE DROP RODS  
"V" GROOVE TRACK WHEELS  
V-TRACK  
HYDRAULIC GATE CLOSERS

## 31 HYDRAULIC GATE CLOSERS, TROLLEYS AND PEDESTALS

SHOTGUN GATE CLOSER  
TROLLEY FOR CANTILEVER GATES  
4 WHEEL TROLLEY  
8 WHEEL TROLLEY  
TROLLEY BRACKETS  
GOOSE NECK PEDESTALS



### PRODUCTS DISPLAYING THIS ICON:

Are warranted to work for  
1 MILLION Cycles\*

Full replacement of product  
for any loss of functionality\*

\* See warranty sheet for details at  
[nationwideindustries.com](http://nationwideindustries.com)

\* CornerStone® hinges tested to 1 million  
cycles on a 6'x4' 75lb privacy gate.

Zip-Latch® Pool Gravity Latch. Nautilus® Self-Closing Hinges.  
Cornerstone® The Million Cycle Self-Closing Nylon Hinges.  
Keystone® Heavy Duty Key-Lockable Latches. Keystone® X eXternal  
Mount Key-Lockable Latches. AquaLatch® Magnetic Pool Safety  
Latches. GateShare® Multi-Lock Latch. Keystone® PanicLatch™ Self-  
Locking PanicLatch™. Manta® Magnetic Nylon Latches. OrnaMAG®  
Magnetic Metal Latches. Trident™ Magnetic Gate Safety Latches.  
ArmorLatch® Magnetic Latches. LockThru® Wood GateSwing Latches.  
V-Notch™ Hinges and Latches. Shotgun® Gate Closers.

# CORNERSTONE® 2 THE MILLION CYCLE HINGE

**PATENTED**

## NEW! CORNERSTONE® 2 NON ADJUSTABLE HINGE

- ▶ Post and Gate flanges: 1"(W) x 1"(D)
- ▶ Heavy duty design produced with durable glass-filled nylon
- ▶ 1/4" Allen wrench included for easy Turn-N-Go™ tension adjustment
- ▶ 20 pair per case @ 33lbs



Point-load tested over 1500 lbs per pair

C2H100N-SD-BK Black w/stainless steel self-drilling screws included  
 C2H100N-SD-WH White w/stainless steel self-drilling screws included  
 C2H100N-ZD-BK Black w/zinc plated steel self-drilling screws included  
 C2H100N-ZD-WH White w/zinc plated steel self-drilling screws included

**PATENTED**

## NEW! CORNERSTONE® 2 SQUARE POST FULLY ADJUSTABLE HINGE

- ▶ Horizontally adjustable to 0.98"
- ▶ Vertically adjustable to 0.875"
- ▶ Fits both right and left-hand applications
- ▶ 1/4" Allen wrench included for easy Turn-N-Go™ tension adjustment
- ▶ 20 pair per case @ 46lbs



Point-load tested to 1500 lbs per pair

C2H200F-SD-BK Black w/stainless steel self-drilling screws included  
 C2H200F-SD-WH White\* w/stainless steel self-drilling screws included  
 C2H200F-ZD-BK Black w/zinc plated steel self-drilling screws included  
 C2H200F-ZD-WH White\* w/zinc plated steel self-drilling screws included  
 \*Special Order

**PATENTED**

## NEW! CORNERSTONE® 2 HEAVY DUTY

### SELF-CLOSING ON GATES UP TO 135 LB

- ▶ Fits both right and left-hand applications
- ▶ C2H121 Includes Alignment tab on Gate Post side
- ▶ 1/4" Allen wrench included for easy Turn-N-Go™ tension adjustment
- ▶ 20 pair per case @ 29lbs
- ▶ White available through special order.

C2H120NB-SD-BK Black w/stainless steel screws  
 C2H121NB-SD-BK Black w/stainless steel screws



Point-load tested to 1700 lbs per pair

## CORNERSTONE® 2 SERIES TECHNOLOGY SELF-CLOSING NYLON HINGES

ALL CornerStone® 2 hinge styles have been tested to 1 MILLION Cycles



**PATENTED**

SHOWN TO THE LEFT  
**CornerStone® 2 Self-Closing Adjustable Hinge**

**C2H100N-SD-BK Fits Square Profiles**

Cornerstone® 2 hinges tested to 1 million weighted cycles on a 6' x 4' 75 lbs privacy gate.



Safe anti-climb design



Turn-N-Go™ tensioning



Easy tension release with most screwdrivers



Heavy duty design



Allen wrench included



# CORNERSTONE® THE MILLION CYCLE HINGE

## CORNERSTONE® SERIES SELF-CLOSING NYLON HINGES



### For Aluminum and Steel Gates

The durability of glass-filled nylon along with high quality manufacturing and design, make the Cornerstone® an ideal choice when you are searching for a very strong, easy-to-install and cost-effective self-closing hinge. With a variety of options available, you will be assured that you have the right hardware for the right application.

- ▶ Heavy Duty Commercial Grade Design
- ▶ Glass-filled nylon construction for superior strength, durability and low maintenance
- ▶ No rusting or staining
- ▶ Available in Black or White

### You Choose the Screws

- ▶ Self-drilling stainless screws for applications in aluminium or
- ▶ Self-drilling zinc plated steel screws for applications in steel



### Easy Tension Adjustment

Just push down and turn. A one-step process that is quick and avoids stripping. Allen wrench included.

**PATENTED**

## CORNERSTONE® NON ADJUSTABLE HINGE

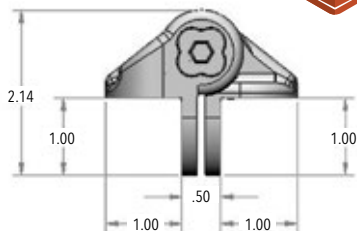

CH100N-SD-BK Black w/stainless steel self-drilling screws included  
 CH100N-SD-WH White w/stainless steel self-drilling screws included  
 CH100N-ZD-BK Black w/zinc plated steel self-drilling screws included  
 CH100N-ZD-WH White w/zinc plated steel self-drilling screws included

- ▶ Post and Gate flanges: 1"(W) x 1"(D)
- ▶ Produced with durable glass-filled nylon
- ▶ 1/4" Allen wrench included for tension adjustment
- ▶ 20 pair per case @ 19lbs

**PATENTED**

## CORNERSTONE® SQUARE POST FULLY ADJUSTABLE HINGE

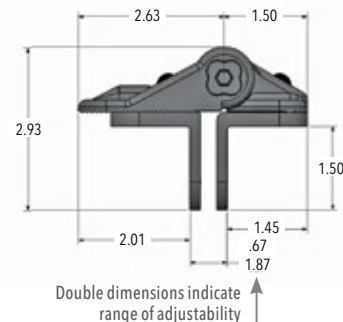

CH200F-SD-BK Black w/stainless steel self-drilling screws included  
 CH200F-SD-WH White w/stainless steel self-drilling screws included  
 CH200F-ZD-BK Black w/zinc plated steel self-drilling screws included  
 CH200F-ZD-WH White w/zinc plated steel self-drilling screws included

- ▶ Horizontally adjustable up to 1 1/4"
- ▶ Vertically adjustable up to 1/2"
- ▶ Fits both right and left hand applications
- ▶ 1/4" Allen wrench included for tension adjustment
- ▶ 20 pair per case @ 40lbs



**PATENTED**

## CORNERSTONE® MINI VERTICALLY ADJUSTABLE HINGE

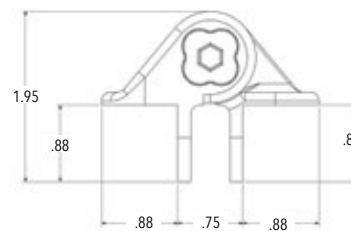

Designed with smaller look for slightly lighter gates  
 Tested to 1 million cycles on a 60lb gate

CH090-SD-BK Black w/stainless steel self-drilling screws included  
 CH090-SD-WH White w/stainless steel self-drilling screws included  
 CH090-ZD-BK Black w/zinc plated steel self-drilling screws included  
 CH090-ZD-WH White w/zinc plated steel self-drilling screws included  
 CH090-NS-BK Black no screws included  
 CH090-NS-WH White no screws included

- ▶ Slotted for vertical adjustability
- ▶ 1/4" Allen wrench included for tension adjustment
- ▶ 20 pair per case @18lbs





# ORNAMENTAL FENCE HINGES

## 4" SELF-CLOSING ALUMINUM HINGE

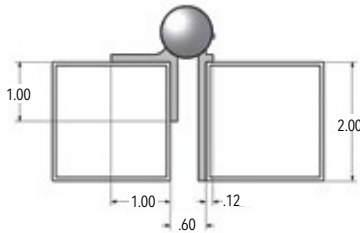

- NW093-26 Black  
NW093-36 Bronze  
NW093-56 White
- ▶ Post flange: 1/8"(W) x 2"(D)
  - ▶ Gate flange: 1"(W) x 1"(D)
  - ▶ Tension adjustment wrench and barrel caps included
  - ▶ 50 each per case @ 25lbs

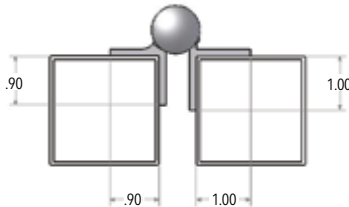

- NW093A-26 (WI-JH501-BK) Black  
NW093A-36 (WI-JH501-BZ) Bronze  
NW093A-56 (WI-JH501-WH) White
- ▶ Both flanges: 1"(W) x 1"(D)
  - ▶ Tension adjustment wrench and barrel caps included
  - ▶ 50 each per case @ 25lbs
- NW093A-2S-26 Black  
NW093A-2S-36 Bronze  
NW093A-2S-56 White
- ▶ Pairs come with self-drilling stainless steel screws and instructions
  - ▶ 25 pairs per case

## 5" SELF-CLOSING ALUMINUM HINGE

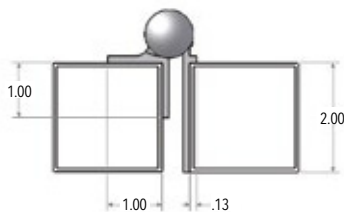

Also includes shim for wall-mount applications

- NW093J-26 (WI-JH500-BK) Black  
NW093J-36 (WI-JH500-BZ) Bronze  
NW093J-56 (WI-JH500-WH) White
- ▶ Post flange: 1/8"(W) x 2"(D)
  - ▶ Gate flange: 1"(W) x 1"(D)
  - ▶ Tension adjustment wrench and barrel caps included
  - ▶ 50 each per case @ 32lbs
- NW093J-2S-26 Black  
NW093J-2S-36 Bronze  
NW093J-2S-56 White
- ▶ Pairs come with self-drilling stainless steel screws and instructions
  - ▶ 25 pairs per case

## PATENTED 5 3/4" SELF-CLOSING ALUMINUM HINGE

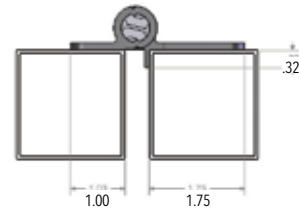

- NW094-BK Black  
NW094-BZ Bronze  
NW094-WH White
- ▶ White is Special Order
  - ▶ Post flange: 1 3/4"(W) x 5/16"(D)
  - ▶ Gate flange: 1"(W)
  - ▶ Adjustable spring tension
  - ▶ 100 each per case @ 55lbs
- NW094-2S-BK Black Pair  
NW094-2S-BZ Bronze Pair  
NW094-2S-WH White Pair
- ▶ White is Special Order
  - ▶ Pairs come with self-drilling stainless steel screws and instructions
  - ▶ 50 pairs per case

## PATENTED

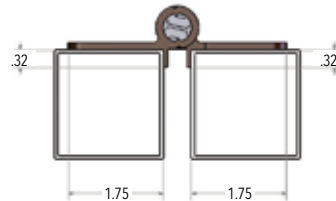

- NW094L-BK Black  
NW094L-BZ Bronze  
NW094L-WH White
- ▶ Both flanges: 1 3/4"(W) x 5/16"(D)
  - ▶ Adjustable spring tension
  - ▶ 100 each per case @ 61lbs
- NW094L-2S-BK Black Pair  
NW094L-2S-BZ Bronze Pair  
NW094L-2S-WH White Pair
- ▶ Pairs come with self-drilling stainless steel screws and instructions
  - ▶ 50 pairs per case

## NEW! NAUTILUS® CONTROLLED CLOSING GATE HINGE



- NTLS-R-AA-BK Active-Active Hinge, Black, Right Hand  
NTLS-R-AD-BK Active-Dummy Hinge, Black, Right Hand  
NTLS-L-AA-BK Active-Active Hinge, Black, Left Hand  
NTLS-L-AD-BK Active-Dummy Hinge, Black, Left Hand
- ▶ Anti-slam technology
  - ▶ Vertically and Horizontally adjustability
  - ▶ Fits both right and left hand applications
  - ▶ Easy to adjust closing speed
  - ▶ 12 pair per case @ 27lbs

\*Active-Active = closing power of 125 lbs.  
\*Active-Dummy = closing power of 75 lbs.



Anti-Slam Technology

USE OUR GUIDE TO DETERMINE IF YOU NEED A LEFT OR RIGHT-HANDED HINGE

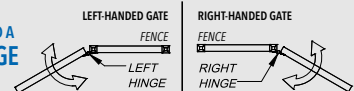



## PATENTED 5 3/4" SELF-CLOSING ALUMINUM HINGE

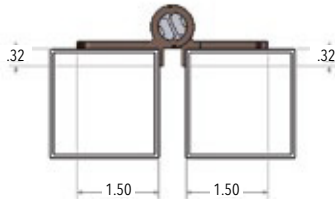

NW096-BK Black  
NW096-BZ Bronze  
NW096-WH White

- ▶ Both flanges: 1 1/2"(W) x 5/16"(D)
- ▶ Adjustable spring tension
- ▶ 100 each per case @ 55lbs

NW096-2S-BK Black Pair  
NW096-2S-BZ Bronze Pair  
NW096-2S-WH White Pair

- ▶ Pairs come with self-drilling stainless steel screws and instructions
- ▶ 50 pairs per case

## PATENTED

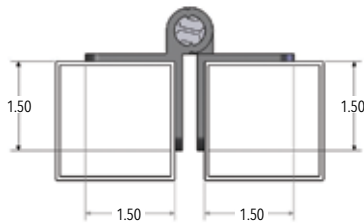

NW095-BK Black  
NW095-BZ Bronze  
NW095-WH White

- ▶ Both flanges: 1 1/2"(W) x 1 1/2"(D)
- ▶ Adjustable spring tension
- ▶ 50 each per case @ 42lbs

NW095-2S-BK Black Pair  
NW095-2S-BZ Bronze Pair  
NW095-2S-WH White Pair

- ▶ Pairs come with self-drilling stainless steel screws and instructions
- ▶ 25 pairs per case

## 4" NON SELF-CLOSING ALUMINUM HINGE

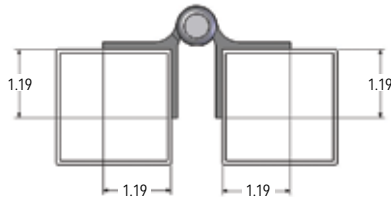

NW149-26 Black

- ▶ Both flanges: 1 3/16"(W) x 1 3/16"(D)
- ▶ 100 each per case @ 39lbs

NW149-2S-26 Black Pair

- ▶ Pairs come with self-drilling stainless steel screws and instructions
- ▶ 50 pairs per case

## HORIZONTAL ADJUSTABLE SELF-CLOSING STAINLESS STEEL HINGE

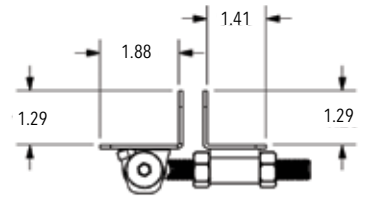

### STRONG CLOSING POWER

NW171SCP5-SSB Black  
NW171SCP5-SSBD\* Black  
NW171SCP5-SSBZD\* Bronze  
\* D=Self-drilling screws

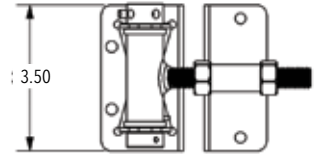

## 2" SQUARE STEEL UNIVERSAL BRACKET

NW6328

- ▶ 50 pairs per case



## 2" SQUARE STEEL LINE BRACKET WITH FASTENERS, BLACK

NW6329

- ▶ 50 each per case



## 1" UNIVERSAL FLAT WALL MOUNT BRACKET, WITH FASTENERS

NW6330

- ▶ 100 pairs per case



Bronze now comes in 2 shades BZ or (-36) is standard dark bronze. BZ2 is a lighter bronze. Check for availability or minimum order quantity.

# HEAVY DUTY SEALED BEARING HINGES

All Hinges have Horizontal Adjustability of approximately 1/2"

## FOR EACH SIDE OF THE HINGE, YOU CHOOSE:

- ▶ Aluminum or Steel material
- ▶ Bolt-on or Weld-on application
- ▶ Black or Mill (unpainted) finish

### Understanding the Part Number

**Material:** A = Aluminum S = Steel  
**Application:** B = Bolt-on W = Weld-on  
**Finish:** M = Mill B = Black\*

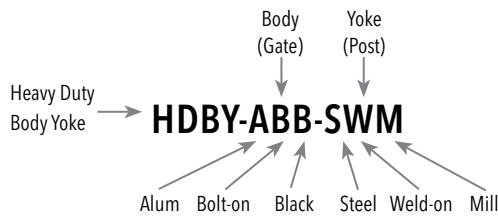

\* Black finish on aluminum and steel is e-coated.

**Body** - the portion of the hinge (with bearings) that rotates

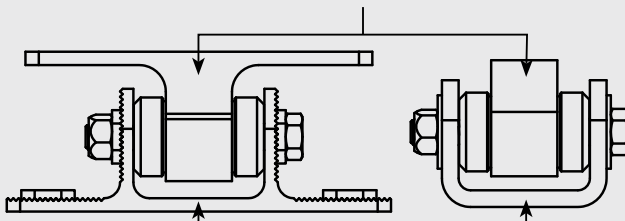

**Yoke** - the bracket portion which holds the body

## Hinge Features:

- ▶ Each hinge contains 2 sealed roller bearings (no grease required)
- ▶ All hinges slotted for horizontal adjustability
- ▶ Rating: 2,500 lbs. per hinge based on factory dynamic rating of bearings\*\*
- ▶ Assembled in the U.S.
- ▶ Warranty: Lifetime on components and 5 years on bearings
- ▶ Unpainted steel hinges are zinc plated.
- ▶ Steel weld-on body fits round or square profiles
- ▶ All hinges sold individually but packaged 8/case.

\*\* On this type of hinge, the mounting bracket is the weak point (not the bearings). Nationwide Industries steel yoke is 15% thicker than competitive products reviewed.

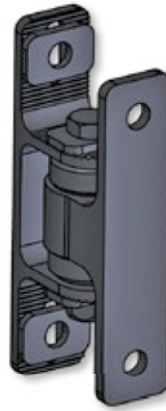

### HDBY-ABB-ABB

- ▶ Body: Alum, Bolt-on, Blk
- ▶ Yoke: Alum, Bolt-on, Blk
- ▶ Gap Min: 2.7"
- ▶ Gap Max: 3.2"
- ▶ Vertical Adjustability: 0.75"
- ▶ Height: 7.2"
- ▶ Weight: 1.5 lbs each

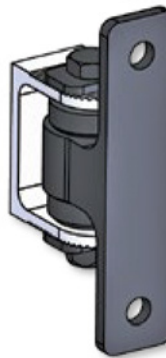

### HDBY-ABB-AWM

- ▶ Body: Alum, Bolt-on, Blk
- ▶ Yoke: Alum, Weld-on, Mill
- ▶ Gap Min: 2.7"
- ▶ Gap Max: 3.2"
- ▶ Hinge Height: 6.5"
- ▶ Weight: 1.4 lbs each



### HDBY-ABB-SBB

- ▶ Body: Alum, Bolt-on, Blk
- ▶ Yoke: Steel, Bolt-on, Blk
- ▶ Gap Min: 3.0"
- ▶ Gap Max: 3.5"
- ▶ Hinge Height: 6.5"
- ▶ Weight: 2.5 lbs each



### HDBY-ABB-SWM

- ▶ Body: Alum, Bolt-on, Blk
- ▶ Yoke: Steel, Weld-on, Mill
- ▶ Gap Min: 2.8"
- ▶ Gap Max: 3.3"
- ▶ Hinge Height: 6.5"
- ▶ Weight: 1.9 lbs each

All Hinges have Horizontal Adjustability of approximately 1/2"

# HEAVY DUTY SEALED BEARING HINGES

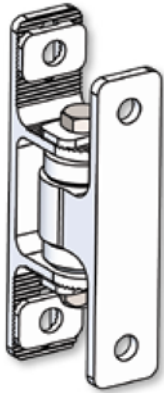

- HDBY-ABM-ABM**
- ▶ Body: Alum, Bolt-on, Mill
  - ▶ Yoke: Alum, Bolt-on, Mill
  - ▶ Gap Min: 2.7"
  - ▶ Gap Max: 3.2"
  - ▶ Vertical Adjustability: 0.75"
  - ▶ Height: 7.2"
  - ▶ Weight: 1.5 lbs each

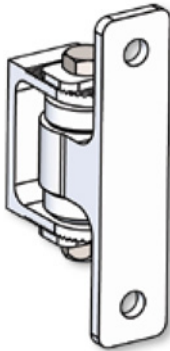

- HDBY-ABM-AWM**
- ▶ Body: Alum, Bolt-on, Mill
  - ▶ Yoke: Alum, Weld-on, Mill
  - ▶ Gap Min: 2.7"
  - ▶ Gap Max: 3.2"
  - ▶ Hinge Height: 6.5"
  - ▶ Weight: 1.4 lbs each

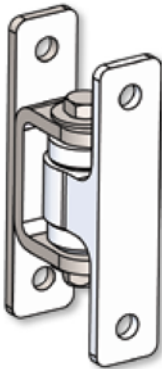

- HDBY-ABM-SBM**
- ▶ Body: Alum, Bolt-on, Mill
  - ▶ Yoke: Steel, Bolt-on, Mill
  - ▶ Gap Min: 3.0"
  - ▶ Gap Max: 3.5"
  - ▶ Hinge Height: 6.5"
  - ▶ Weight: 2.5 lbs each

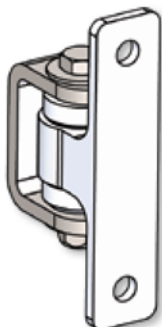

- HDBY-ABM-SWM**
- ▶ Body: Alum, Bolt-on, Mill
  - ▶ Yoke: Steel, Weld-on, Mill
  - ▶ Gap Min: 2.8"
  - ▶ Gap Max: 3.3"
  - ▶ Hinge Height: 6.5"
  - ▶ Weight: 1.9 lbs each

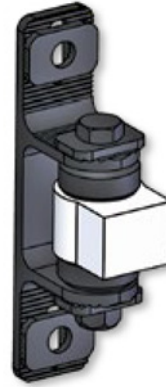

- HDBY-AWM-ABB**
- ▶ Body: Alum, Weld-on, Mill
  - ▶ Yoke: Alum, Bolt-on, Blk
  - ▶ Gap Min: 2.4"
  - ▶ Gap Max: 2.9"
  - ▶ Vertical Adjustability: 0.75"
  - ▶ Height: 7.2"
  - ▶ Weight: 1.3 lbs each

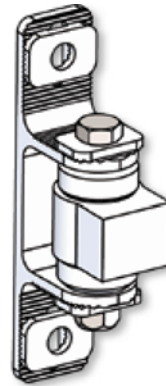

- HDBY-AWM-ABM**
- ▶ Body: Alum, Weld-on, Mill
  - ▶ Yoke: Alum, Bolt-on, Mill
  - ▶ Gap Min: 2.4"
  - ▶ Gap Max: 2.9"
  - ▶ Vertical Adjustability: 0.75"
  - ▶ Height: 7.2"
  - ▶ Weight: 1.2 lbs each

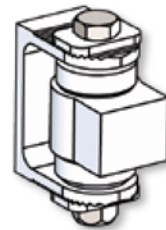

- HDBY-AWM-AWM**
- ▶ Body: Alum, Weld-on, Mill
  - ▶ Yoke: Alum, Weld-on, Mill
  - ▶ Gap Min: 2.4"
  - ▶ Gap Max: 2.9"
  - ▶ Hinge Height: 4.1"
  - ▶ Weight: 1.1 lbs each

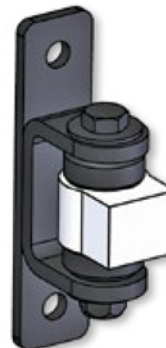

- HDBY-AWM-SBB**
- ▶ Body: Alum, Weld-on, Mill
  - ▶ Yoke: Steel, Bolt-on, Blk
  - ▶ Gap Min: 2.7"
  - ▶ Gap Max: 3.2"
  - ▶ Hinge Height: 6.5"
  - ▶ Weight: 2.3 lbs each

# HEAVY DUTY SEALED BEARING HINGES

All Hinges have Horizontal Adjustability of approximately 1/2"

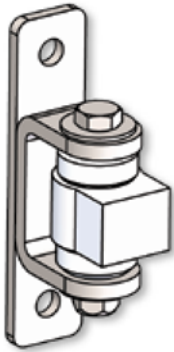

**HDBY-AWM-SBM**

- ▶ Body: Alum, Weld-on, Mill
- ▶ Yoke: Steel, Bolt-on, Mill
- ▶ Gap Min: 2.7"
- ▶ Gap Max: 3.2"
- ▶ Hinge Height: 6.5"
- ▶ Weight: 2.3 lbs each



**HDBY-SBB-SBB**

- ▶ Body: Steel, Bolt-on, Blk
- ▶ Yoke: Steel, Bolt-on, Blk
- ▶ Gap Min: 3.0"
- ▶ Gap Max: 3.5"
- ▶ Height: 6.5"
- ▶ Weight: 3.7 lbs each

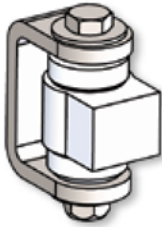

**HDBY-AWM-SWM**

- ▶ Body: Alum, Weld-on, Mill
- ▶ Yoke: Steel, Weld-on, Mill
- ▶ Gap Min: 2.5"
- ▶ Gap Max: 3.0"
- ▶ Hinge Height: 4.1"
- ▶ Weight: 1.6 lbs each



**HDBY-SBB-SWM**

- ▶ Body: Steel, Bolt-on, Blk
- ▶ Yoke: Steel, Weld-on, Mill
- ▶ Gap Min: 2.8"
- ▶ Gap Max: 3.3"
- ▶ Hinge Height: 6.5"
- ▶ Weight: 3.0 lbs each

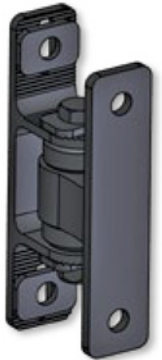

**HDBY-SBB-ABB**

- ▶ Body: Steel, Bolt-on, Blk
- ▶ Yoke: Alum, Bolt-on, Blk
- ▶ Gap Min: 2.7"
- ▶ Gap Max: 3.2"
- ▶ Vertical Adjustability: 0.75"
- ▶ Hinge Height: 7.2"
- ▶ Weight: 2.7 lbs each

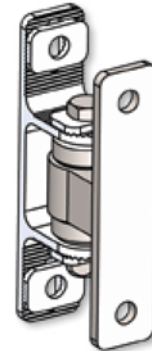

**HDBY-SBM-ABM**

- ▶ Body: Steel, Bolt-on, Mill
- ▶ Yoke: Alum, Bolt-on, Mill
- ▶ Gap Min: 2.7"
- ▶ Gap Max: 3.2"
- ▶ Vertical Adjustability: 0.75"
- ▶ Hinge Height: 7.2"
- ▶ Weight: 2.7 lbs each

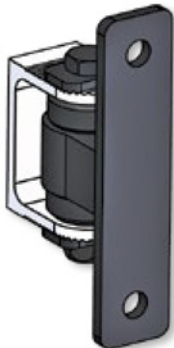

**HDBY-SBB-AWM**

- ▶ Body: Steel, Bolt-on, Blk
- ▶ Yoke: Alum, Weld-on, Mill
- ▶ Gap Min: 2.7"
- ▶ Gap Max: 3.2"
- ▶ Hinge Height: 6.5"
- ▶ Weight: 2.5 lbs each

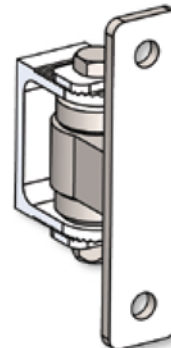

**HDBY-SBM-AWM**

- ▶ Body: Steel, Bolt-on, Mill
- ▶ Yoke: Alum, Weld-on, Mill
- ▶ Gap Min: 2.7"
- ▶ Gap Max: 3.2"
- ▶ Hinge Height: 6.5"
- ▶ Weight: 2.5 lbs each

All Hinges have Horizontal Adjustability of approximately 1/2"

# HEAVY DUTY SEALED BEARING HINGES

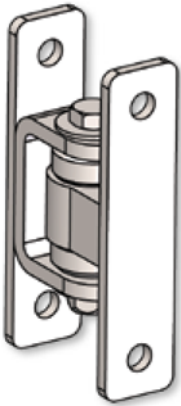

- HDBY-SBM-SBM**
- ▶ Body: Steel, Bolt-on, Mill
  - ▶ Yoke: Steel, Bolt-on, Mill
  - ▶ Gap Min: 3.1"
  - ▶ Gap Max: 3.5"
  - ▶ Height: 6.5"
  - ▶ Weight: 3.7 lbs each

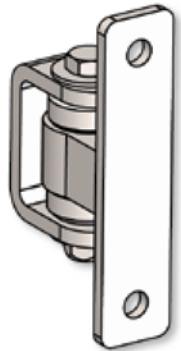

- HDBY-SBM-SWM**
- ▶ Body: Steel, Bolt-on, Mill
  - ▶ Yoke: Steel, Weld-on, Mill
  - ▶ Gap Min: 2.8"
  - ▶ Gap Max: 3.3"
  - ▶ Hinge Height: 6.5"
  - ▶ Weight: 3.0 lbs each



- HDBY-SWM-ABB**
- ▶ Body: Steel, Weld-on, Mill
  - ▶ Yoke: Alum, Bolt-on, Blk
  - ▶ Body fits round or square profile
  - ▶ Gap Min: 2.5"
  - ▶ Gap Max: 3.0"
  - ▶ Vertical Adjustability: 0.75"
  - ▶ Hinge Height: 7.2"
  - ▶ Weight: 2.0 lbs each

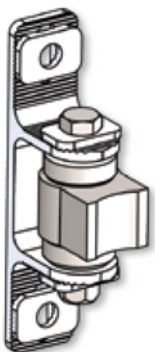

- HDBY-SWM-ABM**
- ▶ Body: Steel, Weld-on, Mil
  - ▶ Yoke: Alum, Bolt-on, Mill
  - ▶ Body fits round or square profile
  - ▶ Gap Min: 2.5"
  - ▶ Gap Max: 3.0"
  - ▶ Vertical Adjustability: 0.75"
  - ▶ Hinge Height: 7.2"
  - ▶ Weight: 2.0 lbs each

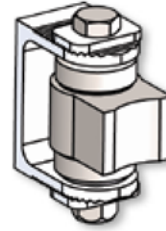

- HDBY-SWM-AWM**
- ▶ Body: Steel, Weld-on, Mill
  - ▶ Yoke: Alum, Weld-on, Mill
  - ▶ Body fits round or square profile
  - ▶ Gap Min: 2.5"
  - ▶ Gap Max: 3.0"
  - ▶ Height: 4.1"
  - ▶ Weight: 1.8 lbs each

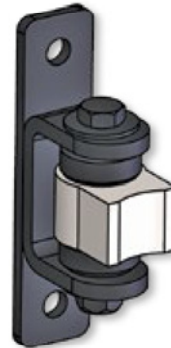

- HDBY-SWM-SBB**
- ▶ Body: Steel, Weld-on, Mill
  - ▶ Yoke: Steel, Bolt-on, Blk
  - ▶ Body fits round or square profile
  - ▶ Gap Min: 2.8"
  - ▶ Gap Max: 3.3"
  - ▶ Hinge Height: 6.5"
  - ▶ Weight: 3.0 lbs each

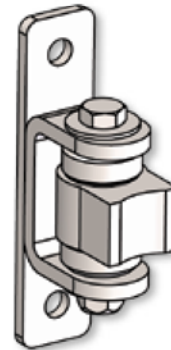

- HDBY-SWM-SBM**
- ▶ Body: Steel, Weld-on, Mill
  - ▶ Yoke: Steel, Bolt-on, Mill
  - ▶ Body fits round or square profile
  - ▶ Gap Min: 2.8"
  - ▶ Gap Max: 3.3"
  - ▶ Hinge Height: 6.5"
  - ▶ Weight: 3.0 lbs each

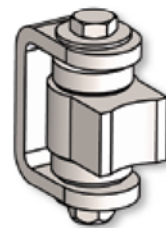

- HDBY-SWM-SWM**
- ▶ Body: Steel, Weld-on, Mill
  - ▶ Yoke: Steel, Weld-on, Mill
  - ▶ Body fits round or square profile
  - ▶ Gap Min: 2.6"
  - ▶ Gap Max: 3.0"
  - ▶ Hinge Height: 4.1"
  - ▶ Weight: 2.3 lbs each



- HDBYSC-SWM-SWM**
- ▶ Body: Steel, Weld-on, Mill
  - ▶ Yoke: Steel, Weld-on, Mill
  - ▶ Set includes one self-closing hinge and one dummy hinge (HDBY-SWM-SWM)



# ORNAMENTAL HEAVY DUTY GATE HINGES

## HEAVY DUTY NON SELF-CLOSING ALUMINUM HINGE

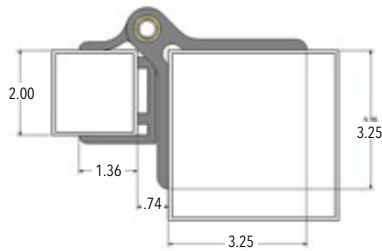

NW216-26 (WI-AIH-BK) Black  
 NW216-36 (WI-AIH-BZ) Bronze  
 NW216-56 (WI-AIH-WH) White

- ▶ Post flange: 5"(H) x 3 1/4"(W) x 3 1/4"(D)
- ▶ Gate flange: 2 3/8"(H) x 1 5/16"(W) x 2"(D)
- ▶ Gate flange will accommodate both 2" and 1" gate frame
- ▶ 20 each per case @ 34lbs

WI-AIH-2.5-BK Black

- ▶ Gate flange: 2 1/2"
- ▶ 20 each per case @ 35lbs

## HEAVY DUTY BLOCK HINGE FOR ALUMINUM GATE

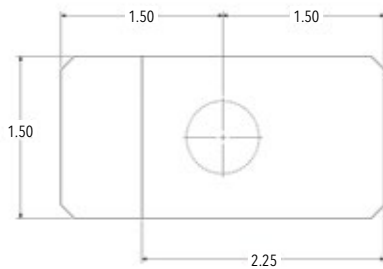

NW6189 (WI-BH)

- ▶ Aluminum
- ▶ Beveled corners, designed to be welded
- ▶ 18 each per case @ 45lbs
- ▶ Brass bushings and heavy duty stainless steel pin
- ▶ No grease required

WI-BH-SA

- ▶ Aluminum to steel block
- ▶ 10 each per case 30lbs

WI-BH-STEEL

- ▶ Steel to steel block
- ▶ 10 each per case

## HEAVY DUTY STEEL BARREL HINGE

NW6215R-BK Black

NW6215L-BK Black

- ▶ Contains grease fitting
- ▶ Steel power coated
- ▶ 6 each per case @ 22lbs

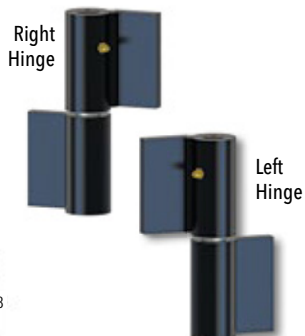
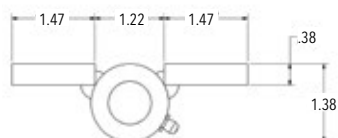

## HEAVY DUTY ESTATE GATE HINGE

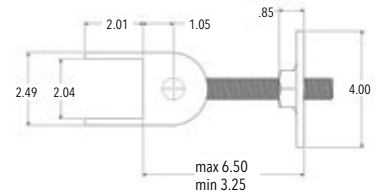

**Rotating Nut Design that adjusts without removing the gate**

NW6218 (WI-EH-ASM) Mill (2")

NW6218-BK Black (2")

NW6218-25 Mill (2 1/2")

NW6318S-20 (2")

NW6318S-20H (2") w/mounting holes

NW6318S-25 (2 1/2")

NW6318S-25H (2 1/2) w/mounting holes

- ▶ Horizontal adjustability
- ▶ Has an aluminum block for welding
- ▶ Acetal bushing
- ▶ Stainless steel hinge pin
- ▶ Zinc plated steel mounting plate.
- ▶ Fits 2" or 2 1/2" size gate frame.
- ▶ Ships unassembled (weld block to gate, then assemble)
- ▶ 12 each per case @ 40lbs

## LARGE HEAVY DUTY BALL BEARING HINGE

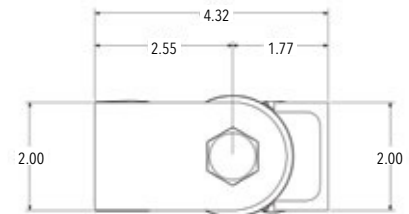

NW6229

- ▶ Zinc plated steel
- ▶ Sealed ball bearings
- ▶ No grease required
- ▶ 4" tall
- ▶ 12 each per case @ 44lbs

## HEAVY DUTY ESTATE GATE HINGE WITH ADJUSTABILITY

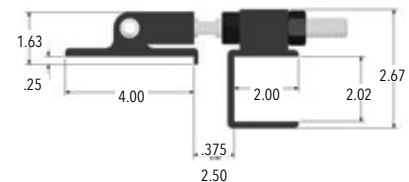

NW6242-B-BK Black Bolt-on (bolts included)

NW6242-W-BK Black Weld-on (Special Order)

- ▶ Fits 2" gate frames and posts 4" or larger
- ▶ Aluminum and stainless steel construction
- ▶ Great strength, and horizontal adjustability
- ▶ 8 each per case @ 28lbs

**All Lockable Latches can be Keyed Alike**  
 When Ordering: Add KA to the end of the Part Number

# ORNAMENTAL FENCE LATCHES

**PATENTED**

## KEYSTONE® SERIES



**HEAVY DUTY DESIGN WITH WEATHER RESISTANT GLASS-FILLED NYLON CONSTRUCTION**

### LATCH SIDE

Re-keyable cylinder

Stainless steel striker bar with anti-pull through enlarged tip

Bottom thumb latch protected from rain and dirt

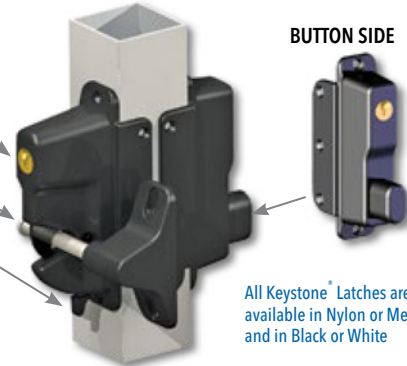

### BUTTON SIDE

All Keystone® Latches are available in Nylon or Metal and in Black or White

### TWO-SIDED LOCKABLE LATCH - NYLON

- KLADV-P2-BK Black
- KLADV-P2-WH White
- KLADV-P2ZD-BK Black
- KLADV-P2ZD-WH White

- ▶ Locking feature accessible from both sides
- ▶ Reversible for right-hand or left-hand use
- ▶ Glass-filled nylon housing
- ▶ Thumb release button on one side, gravity latch lever on opposite side
- ▶ Can be used on 1-3/4"-5" posts
- ▶ 20 each per case @ 23lbs



All Keystone® 2-Sided Latches are packed with a durable Plastic Marking Template for installation.

### TWO-SIDED LOCKABLE LATCH - METAL

- KLADV-M2-BK Black
- KLADV-M2-WH White
- KLADV-M2ZD-BK Black
- KLADV-M2ZD-WH White

- ▶ Same as KLADV-P2 but with zinc die cast housing
- ▶ 20 each per case @ 48lbs



Heavy Duty Striker Design on every Keystone® Latch

### ONE-SIDED LOCKABLE LATCH - NYLON

- KLADV-P1-BK Black
- KLADV-P1-WH White
- KLADV-P1ZD-BK Black
- KLADV-P1ZD-WH White

- ▶ Same as KLADV-P2 above but with locking (gravity latch lever) on one side
- ▶ 20 each per case @ 17lbs



One-Sided Lockable Latch

### ONE-SIDED LOCKABLE LATCH - METAL

- KLADV-M1-BK Black
- KLADV-M1-WH White
- KLADV-M1ZD-BK Black
- KLADV-M1ZD-WH White

- ▶ 20 each per case @ 31lbs



## KEYLESS LOCK FOR ORNAMENTAL GATES

- ▶ Mechanical Combination Locks- No electronics
- ▶ Passage function may be set for entering/exiting without code
- ▶ Deadlocking spring latch - locks automatically
- ▶ Marine Grade finishes available (Jet Black & Satin Chrome)
- ▶ Slip clutch design - no damage to lock if handle is pushed down too hard

### NO NEED FOR A LOCK BOX & NO WELDING

### SEE PAGE 28 FOR FULL KEYLESS LOCK PRODUCT LINE



### 2835-ADAPTER

- ▶ Keeper has vertical adjustment and needs to be located on the post
- ▶ Fits a gate frame of 2"-5"
- ▶ Reversible for left and right handed use
- ▶ 10 per box at 15lbs

**PATENTED**

## NEW! KEYSTONE® PANICLATCH™



### KPL-P2-BK Black

- ▶ Self-Locking anti-tamper design
- ▶ Easy exit with large button
- ▶ Secure Entry with 6 pin key
- ▶ 6 each per case @20lbs

### FUNCTIONS LIKE A PANIC BAR BUT MADE FOR GATES



# ORNAMENTAL FENCE LATCHES

All Lockable Latches can be Keyed Alike  
When Ordering: Add KA to the end of the Part Number

**PATENTED**



## THE KEYSTONE® X-EXTERNAL MOUNT LATCH

BEST STAINLESS STEEL EXTERNAL  
SPINDLE DESIGN IN THE INDUSTRY

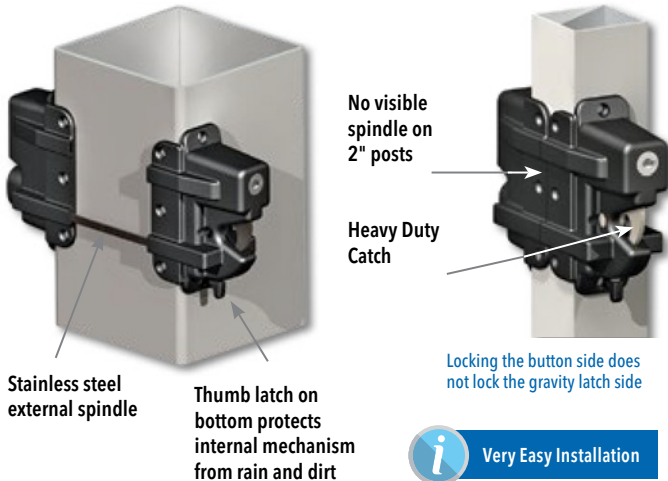

### NO NEED TO DRILL SPINDLE HOLES

- KLX-P2-BK Black
- KLX-P2-WH White
- KLX-P2ZD-BK Black
- KLX-P2ZD-WH White
- ▶ Marked in 1/2" increments for quick, easy and accurate fitting to post sizes 2" - 5"
- ▶ Flat design safely encloses spindle ends
- ▶ 20 each per case @ 22lbs



- KLX-P1-BK Black
- KLX-P1-WH White
- KLX-P1ZD-BK Black
- KLX-P1ZD-WH White
- ▶ Features Latch only
- ▶ 20 each per case @ 15lbs

### SAME KLX LATCH, WITH SLIMLINE DESIGN

- KLX2-P2-BK Black
- KLX2-P2-WH White
- KLX2-P2ZD-BK Black
- KLX2-P2ZD-WH White
- ▶ Slimline design
- ▶ 20 each per case @ 20lbs

- KLX2-P1-BK Black
- KLX2-P1-WH White
- KLX2-P1ZD-BK Black
- KLX2-P1ZD-WH White
- ▶ Features Latch only
- ▶ 20 each per case @ 13lbs



**PATENTED**



## TRIDENT™ MAGNETIC GATE LATCH

by NATIONWIDE INDUSTRIES

The TRIDENT™ SAFETY GATE LATCH has a significant amount of play or vertical tolerance. This helps to avoid problems with sagging gates, and allows for simple installation.



Number	Color	Quantity / Weight
TRIDENT20-BK	Black	20/Case @ 29lbs
TRIDENT20-WH	White	20/Case @ 29lbs
TRIDENT10-BK	Black	20/Case @ 20lbs
TRIDENT10-WH	White	20/Case @ 20lbs



**PATENTED**

## AQUALATCH®

The MAGNETIC Gate Safety Lock with **SAFE-ALERT®**



### AQUALATCH®...magnetic closing power, easy installation and guaranteed to last!

- ▶ Heavy duty construction
- ▶ Beautiful, modern design
- ▶ Multi-directional leveling for misaligned gates
- ▶ Excellent horizontal and vertical adjustability
- ▶ Fits right or left handed gates
- ▶ Industry-BEST Warranty

\*Please check local pool codes prior to use.

Number	Color	Description	Quantity / Weight
AQUA10-BK	Black	AquaLatch® w/Std Keeper	20/Case @ 33lbs
AQUA10-WH	White	AquaLatch® w/Std Keeper	20/Case @ 33lbs
AQUA10H-BK	Black	AquaLatch® w/Handle/Keeper	20/Case @ 33lbs
AQUA10H-WH	White	AquaLatch® w/Handle/Keeper	20/Case @ 33lbs
AQUA20-BK	Black	AquaLatch® w/Std Keeper	20/Case @ 36lbs
AQUA20-WH	White	AquaLatch® w/Std Keeper	20/Case @ 36lbs
AQUA20H-BK	Black	AquaLatch® w/Handle/Keeper	20/Case @ 36lbs
AQUA20H-WH	White	AquaLatch® w/Handle/Keeper	20/Case @ 36lbs

## MAGNETIC SAFETY LATCHES

### THE PROTECTOR®

NW276NE-26 Black  
NW276NE-56 White

**19.5" latch height meets pool access requirements when properly installed**

- ▶ Horizontal and vertical adjustment up to 2"
- ▶ Reversible for right-hand or left-hand use
- ▶ Easy-grip release knob
- ▶ Key cylinder is at a 45° angle for easy access
- ▶ Extruded aluminum body with glass-filled nylon components
- ▶ Packaged in heavy-duty poly bag with stain less steel screws
- ▶ 20 each per case @ 30lbs

Key cylinder at 45° for easy access and protection from water and debris



### THE PROTECTOR® JR.

NW308-26 Black  
NW308-56 White

- ▶ Same as NW276NE but used for applications with taller fence profiles
- ▶ Total latch height is 10"
- ▶ 20 each per case @ 23lbs

Latch height is 10"



### STAINLESS STEEL GRAVITY LATCH

NW38204SSB Black  
NW38204SSW White  
NW38204SSM Mill  
NW38204-SS-BZ Bronze

- ▶ Pad-lockable on one side
- ▶ Stainless steel screws included
- ▶ 50 each per case @ 28lbs



### ROUND POST ADAPTER FOR CHAIN LINK

FITS AQUALATCH®, TRIDENT™ AND PROTECTOR®

### NEW! HIDDEN SPRING LATCHES

NW6283-SSB Black w/stainless steel screws included  
NW6283-SSBD Black w/stainless steel self-drilling screws included  
NW6283-SSW White w/stainless steel screws included  
NW6283-SSWD White w/stainless steel self-drilling screws included

- ▶ Suitable for 1-1/4"-2-1/2" gate frames
- ▶ Can be used for Double Drive Gates
- ▶ Pad-Lockable on both sides
- ▶ 20 each per case @ 25lbs



# ORNAMENTAL FENCE LATCHES

All Lockable Latches can be Keyed Alike  
When Ordering: Add KA to the end of the Part Number

**PATENTED**

*Built with Strength and Integrity*



## ARMORLATCH®

GREAT FOR ORNAMENTAL AND VINYL GATES



Glass-filled nylon material for low maintenance, with a strong look and feel

- ▶ Locks & unlocks from either side
- ▶ Add aluminum cover plates for metal look and color
- ▶ Re-keyable to home locks
- ▶ Reversible for left or right hand use
- ▶ Easy installation including horizontal & vertical adjustability
- ▶ Works with double drive gates
- ▶ Fits gate frames from 1-1/2" to 5" deep



Shown with white cover plate

Number	Description	Qty/Case	Weight
NW6244-SD-FB	Flat Black w/self-drilling stainless steel screws	10	21lbs
NW6244-FB	Flat Black w/non self-drilling stainless steel screws	10	21lbs
NW6244CV-BK	Cover Plates Glossy Black	10	6lbs
NW6244CV-MI	Cover Plates Unpainted	10	6lbs
NW6244CV-WH	Cover Plates White	10	6lbs
NW6244CV-BZ	Cover Plates Bronze	10	6lbs

**PATENTED**

## ORNAMAG®

### MAGNETIC GATE LATCH



- OM-L-BK Black
- OM-L-BZ Bronze
- OM-L-WH White
- ▶ Accommodates up to 2" gate post profile
- ▶ Key locking
- ▶ Reversible for right-hand or left-hand use
- ▶ Self-drilling stainless steel screws and self-drilling steel screws included
- ▶ Great for double drive gates
- ▶ 10 each per case @ 27lbs

Back Plates Included to Accommodate Gate Gap Variance

Back Plate Gap Range:

- ▶ Standard Back Plate 5/16" to 13/16"
- ▶ Offset Back Plate 3/16" to 1-7/16"

### FLIP LATCH

NW6169-BK Black

- ▶ Commercial grade
- ▶ Pad-lockable
- ▶ Zinc plate steel with black powder coated finish
- ▶ Stainless steel through-bolts
- ▶ 10 per case @ 37lbs



WI-DGFL Black

- ▶ Teflon Coated
- ▶ Pad-lockable
- ▶ 12 each per case @ 56 lbs



### FULCRUM LATCH

2 1/2" Post Size

- WI-FL-2-1/2 (NW7060)
- WI-FL-2-1/2-BK (NW7060-BK)
- ▶ 6 each per case @ 22lbs

3" Post Size

- WI-FL-3 (NW7061)
- WI-FL-3-BK (NW7061-BK)
- ▶ 6 each per case @ 24lbs

4" Post Size

- WI-FL-4 (NW7062)
- WI-FL-4-BK (NW7062-BK)
- ▶ 6 each per case @ 24lbs
- ▶ Heavy Duty Latch for Large Single Swing Gates
- ▶ Fits 2" Gate Frames

6-5/8" Post Size

- WI-FL-6-5/8
- WI-FL-6-5/8-BK
- ▶ 6 each per case



**PATENTED**



## MAGNETIC LATCH

- ▶ Self-latching and key-lockable
- ▶ Glass-filled nylon material for low maintenance, strength and durability
- ▶ Locks & unlocks from either side
- ▶ Reversible for left or right hand use without changing components

Number	Qty/Case	Weight
MANTA-L-BK	12	21 lbs
MANTA-L-WH	12	21 lbs





# ORNAMENTAL FENCE LATCHES & POST CAPS

## MAGNETIC SIDE PULL SPL 100 LATCH

### SPL100-SD-BK

- ▶ Designed for small gates
- ▶ Stainless steel screws included
- ▶ Screws hidden by cover plates
- ▶ Fits 1 1/4" or larger profile
- ▶ 20 each per case @ 8lbs



Side Pull Latches Require a Gate Bumper

## MODERN POST CAP – PRESS FIT

Custom Logos Available  
(requires minimum run quantity)

### WI-IPC-200 Mill

- ▶ 2" Aluminum Post Cap
- ▶ Shorter lip than the NW230NL Series
- ▶ 250 per case @ 22lbs

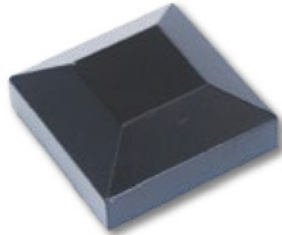

### NW230NL-SBL (WI-RPC-2NL) Mill

### NW230NL-26 (WI-RPC-2NL-BK) Black

### NW230NL-36 (WI-RPC-2NL-BZ) Bronze

### NW230NL-BZ2 Lt. Bronze

### NW230NL-56 (WI-RPC-2NL-WH) White

- ▶ 2" Aluminum die cast
- ▶ 250 each per case @ 22lbs

### WI-IPC-250 Mill

- ▶ 2.5" Aluminum Post Cap
- ▶ Shorter lip than the NW240NL
- ▶ 320 per case @ 39 lbs

### NW291-SBL Mill

- ▶ 1.5" Aluminum die cast
- ▶ 500 each per case @ 27lbs
- ▶ Colors available with special order

### NW240NL-SBL Mill

### NW240NL-26 Black

### NW240NL-36 Bronze

### NW240NL-56 White

- ▶ 2.5" Aluminum die cast
- ▶ 300 each per case @ 41lbs

### NW6276-SBL Mill

### NW6276-BK Black

- ▶ 6" Aluminum die cast
- ▶ Sandblast finish
- ▶ 50 each per case @ 47lbs

### Plastic

### NW6230-BK Black

- ▶ 2" Plastic post cap
- ▶ 325 each per case @ 15lbs

### WI-IPC-300 Mill

- ▶ 3" Aluminum Post Cap
- ▶ 300 per case @ 39 lbs

### WI-IPC-400 Mill

- ▶ 4" Aluminum Post Cap
- ▶ 144 per case @ 39 lbs

### WI-IPC-150 Mill

- ▶ 1.5" Aluminum Post Cap
- ▶ Shorter lip than the NW291
- ▶ 500 per case @ 25 lbs

## TRADITIONAL POST CAP – PRESS FIT

### Zinc

### NW220-MI Mill

- ▶ 2" Zinc die cast
- ▶ 250 each per case @ 39lbs

### NW244-MI Mill

- ▶ 2.5" Zinc die cast
- ▶ 120 each per case @ 25lbs



### Aluminum

### NW6099-MI Mill

### NW6099-BK Black

### NW6099-BZ Bronze (Special Order)

### NW6099-WH White

- ▶ 2" Aluminum die cast
- ▶ 250 each per case @ 22lbs

### NW6098-SBL Mill

### NW6098-BK Black

### NW6098-BZ Bronze

### NW6098-WH White (Special Order)

- ▶ 3" Aluminum die cast
- ▶ 100 each per case @ 23lbs

### NW6196-SBL Mill

### NW6196-BK Black

### NW6196-BZ Bronze

### NW6196-WH White (All Special Order)

- ▶ 2.5" Aluminum die cast
- ▶ 250 each per case @ 23lbs

### NW6084-MI Mill

### NW6084-BK Black

### ▶ 4" Aluminum die cast

- ▶ 100 each per case @ 35lbs

## STEEL POST CAPS

### NW6208-BK Black (Special Order)

- ▶ 1" Stamped steel
- ▶ 250 each per case @ 36lbs

### NW6209-BK Black (Special Order)

- ▶ 1.5" Stamped steel
- ▶ 250 each per case @ 36lbs



### NW6210-BK Black

- ▶ 2" Stamped steel
- ▶ 250 each per case @ 36lbs



### NW6211-BK Black

- ▶ 2.5" Stamped steel

### NW6212-BK Black

- ▶ 3" Stamped steel
- ▶ 100 each per case @ 29lbs



### NW6213-BK Black

- ▶ 4" Stamped steel
- ▶ 50 each per case @ 26lbs



# ORNAMENTAL FENCE BALL CAPS



## BALL CAPS – PRESS FIT

Custom Logos Available  
(requires minimum run quantity)

The Ball Caps below are also available with hole for set screws.

When Ordering: add an "H" after the number in the part number.

Examples: **NW6166H-MI Mill**  
**NW6191H-SBL Mill**



**NW6166-MI Mill**  
**NW6166-BK Black**  
**NW6166-BZ Bronze**  
**NW6166-WH White**  
▶ 2" Aluminum die cast - ball cap  
▶ 50 each per case @ 15lbs

**NW6179-SBL Mill**  
**NW6179-BK Black**  
**NW6179-BZ Bronze**  
**NW6179-WH White (Special Order)**  
▶ 2.5" Aluminum die cast - ball cap  
▶ 50 each per case @ 18lbs

**NW6191-SBL Mill**  
**NW6191-BK Black**  
**NW6191-BZ Bronze (Special Order)**  
**NW6191-WH White (Special Order)**  
▶ 3" Aluminum die cast - ball cap  
▶ 50 each per case @ 20lbs

**NW6193-MI Mill**  
**NW6193-BK Black**  
**NW6193-BZ Bronze (Special Order)**  
**NW6193-WH White (Special Order)**  
▶ 4" Aluminum die cast - ball cap  
▶ 50 each per case @ 42lbs

**NW242-SBL Mill**  
▶ 2" Aluminum die cast - Screw Set  
▶ 72 each per case @ 41lbs

**NW242A-MI Mill**  
▶ 2" Aluminum die cast - Press Fit  
▶ 72 per case @ 41lbs

**NW242B-SBL Mill (Special Order)**  
**NW242B-BK Black**  
▶ Fits a True 2" post  
▶ Aluminum die cast - Press Fit  
▶ 72 per case @ 41lbs

**WI-IBC-200 Mill**  
▶ 2" Aluminum Die Cast

**WI-IBC-250 Mill**  
**WI-IBC-250-BK Black**  
▶ 2.5" Aluminum Die Cast

**WI-IBC-300 Mill**  
▶ 3" Aluminum Die Cast

**UBC4 Mill**  
▶ 4" Aluminum Die Cast  
▶ All 50 per case



**NW290A-SBL Mill**  
▶ 2.5" Aluminum die cast - Press Fit  
▶ 80 each per case @ 43lbs

**NW6097-SBL Mill**  
▶ 3" Aluminum die cast - Press Fit  
▶ 50 each per case @ 34lbs



# ORNAMENTAL FENCE FINIALS



NW233PF, NW234PF  
NW235PF, NW236PF



NW212, NW213,  
NW245, NW246, NW249  
NW250, NW251, NW252

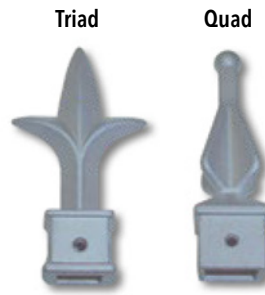

NW233, NW234  
NW235, NW236

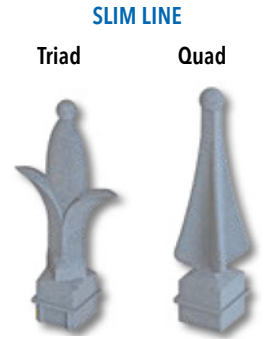

NW6200, NW6201, NW6202  
NW6203, NW6204, NW6205  
NW6206, NW6207

**Mill Finish On All Finials** Some Finials May Be Special Order. Please Contact Customer Service for Availability.

When ordering Color, Substitute the MI or SBL in the Item No. with BK (Black), BZ (Bronze), BZ2 (Bronze), or WH (White).

ITEM NO	STYLE	WITH HOLE	PRESS FIT or SLIP-ON	MATERIAL	OPTIMUM PICKET O.D.	QTY/CASE	WEIGHT / CASE
<b>5/8"</b>							
NW233-MI	Triad	Y	SO	Aluminum	0.635	300	42
NW233PF-SBL	Triad	N	PF	Aluminum	0.600	300	42
NW233PFH-SBL	Triad	Y	PF	Aluminum	0.600	300	42
NW235-SBL	Quad	Y	SO	Aluminum	0.635	300	45
NW235PF-SBL	Quad	N	PF	Aluminum	0.600	300	45
NW235PFH-SBL	Quad	Y	PF	Aluminum	0.600	300	45
NW6202-SBL	Quad	N	SO	Aluminum	0.600	300	23
NW6202H-SBL	Quad	Y	SO	Aluminum	0.600	300	23
NW6202HA-SBL	Quad	Y	SO	Aluminum	0.625	300	23
NW6202PFTS-SBL	Quad	N	PF	Aluminum	0.600	300	23
NW6206-SBL	Triad	N	SO	Aluminum	0.600	300	23
NW6206H-SBL	Triad	Y	SO	Aluminum	0.600	300	23
NW6206PFTS-SBL	Triad	N	PF	Aluminum	0.600	300	23
NW212-MI	Quad	N	PF	Zinc	0.600	250	42
NW213-MI	Triad	N	SO	Zinc	0.600	250	42
NW6231-SBL	Fleur de Lis	N	SO	Aluminum	0.600	300	27
NW6231H-SBL	Fleur de Lis	Y	SO	Aluminum	0.600	300	27
NW6231PFTS-SBL	Fleur de Lis	N	PF	Aluminum	0.600	300	27
NW6253-SBL	Fleur de Lis	N	PF	Aluminum	0.600	300	41
<b>3/4"</b>							
NW234-MI	Triad	Y	SO	Aluminum	0.750	300	51
NW234PF-SBL	Triad	N	PF	Aluminum	0.720	300	51
NW234PFH-SBL	Triad	Y	PF	Aluminum	0.720	300	51
NW234PF75-SBL	Triad	N	PF	Aluminum	0.750	300	51
NW234PFH75-SBL	Triad	Y	PF	Aluminum	0.750	300	51



Fleur De Lis  
NW6231, NW6232



NW6253  
Larger Fleur de Lis  
on standard base



NW6277-SBL  
1" Fleur de Lis  
sandblast finish

# ORNAMENTAL FENCE FINIALS

ITEM NO	STYLE	HOLE	PRESS FIT or SLIP-ON	MATERIAL	OPTIMUM PICKET O.D.	QTY/CASE	WEIGHT / CASE
<b>3/4" Continued</b>							
NW236-SBL	Quad	Y	SO	Aluminum	0.750	300	51
NW236PF-SBL	Quad	N	PF	Aluminum	0.720	300	51
NW236PFH-SBL	Quad	Y	PF	Aluminum	0.720	300	51
NW236PF75-SBL	Quad	N	PF	Aluminum	0.750	300	51
NW236PFH75-SBL	Quad	Y	PF	Aluminum	0.750	300	51
NW6201-SBL	Quad	N	SO	Aluminum	0.720	300	26
NW6201H-SBL	Quad	Y	SO	Aluminum	0.720	300	26
NW6201PFTS-SBL	Quad	N	PF	Aluminum	0.750	300	26
NW6205-SBL	Triad	N	SO	Aluminum	0.720	300	28
NW6205H-SBL	Triad	Y	SO	Aluminum	0.720	300	28
NW6205PFTS-SBL	Triad	N	PF	Aluminum	0.750	300	28
NW249-MI	Quad	N	SO	Zinc	0.750	250	49
NW249IT-MI	Quad	N	PF	Zinc	0.750	250	49
NW250IT-MI	Triad	N	PF	Zinc	0.750	250	46
NW250-MI	Triad	N	SO	Zinc	0.750	250	46
NW6232-SBL	Fleur de Lis	N	SO	Aluminum	0.750	300	26
NW6232H-SBL	Fleur de Lis	Y	SO	Aluminum	0.750	300	26
NW6232PFTS-SBL	Fleur de Lis	N	PF	Aluminum	0.750	300	26
<b>1"</b>							
NW6200-SBL	Quad	N	SO	Aluminum	1.00	300	31
NW6200H-SBL	Quad	Y	SO	Aluminum	1.00	300	31
NW6204-SBL	Triad	N	SO	Aluminum	1.00	300	29
NW6204H-SBL	Triad	Y	SO	Aluminum	1.00	300	29
NW245-MI	Quad	N	SO	Zinc	1.00	200	41
NW245IT-MI	Quad	N	PF	Zinc	1.00	200	41
NW246-MI	Triad	N	SO	Zinc	1.00	200	41
NW246IT-MI	Triad	N	PF	Zinc	1.00	200	41
NW6277-SBL	Fleur de Lis	N	SO	Aluminum	1.00	200	42
NW6277H-SBL	Fleur de Lis	Y	SO	Aluminum	1.00	200	42
<b>5/8" X 1"</b>							
NW6203-SBL	Quad	N	SO	Aluminum	.600 X 1.00	300	29
NW6203H-SBL	Quad	Y	SO	Aluminum	.600 X 1.00	300	29
NW6203PFTS-SBL	Quad	N	PF	Aluminum	.600 X 1.00	300	29
NW6207-SBL	Triad	N	SO	Aluminum	.600 X 1.00	300	26
NW6207H-SBL	Triad	Y	SO	Aluminum	.600 X 1.00	300	26
NW6207PFTS-SBL	Triad	N	PF	Aluminum	.625 X 1.00	300	26
NW251-MI	Quad	N	SO	Zinc	.600 X 1.00	200	38
NW252-MI	Triad	N	SO	Zinc	.600 X 1.00	200	38



# ORNAMENTAL WALL MOUNT BRACKETS

## SWIVEL BALL BRACKET BASES

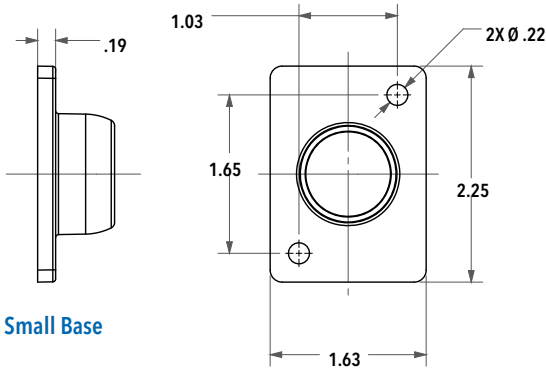

Small Base

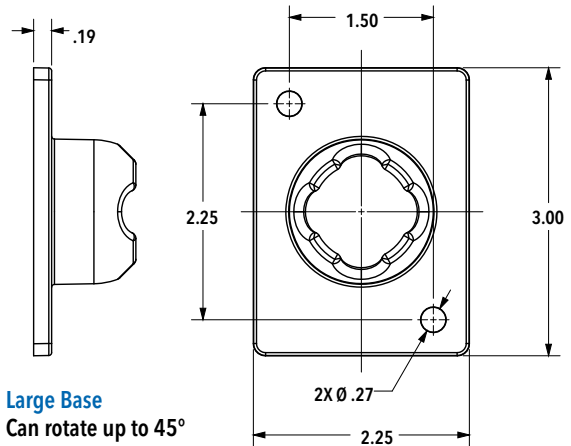

Large Base  
Can rotate up to 45°

1" X 1"

### SQUARE DUAL FLANGE WALL MOUNT BRACKET

- NW280-SBL Mill
- NW280-BK Black
- NW280-BZ Bronze (Special Order)
- NW280-BZ2 Light Bronze (Special Order)
- NW280-WH White (Special Order)
- ▶ 1" x 1"
- ▶ Aluminum die cast
- ▶ 500 per case @ 44lbs



1" X 1 1/8"

### SINGLE FLANGE WALL MOUNT BRACKET

- NW211-MI Mill
- ▶ 1" x 1 1/8"
- ▶ Rounded Top Corners
- ▶ Aluminum die cast
- ▶ 300 each per case @ 38lbs
- NW211-MI-2 Mill
- NW211-BK-2 Black
- ▶ 1" x 1 1/8"
- ▶ Squared in all Corners
- ▶ Aluminum die cast
- ▶ 300 each per case @ 38lbs



### SWIVEL BALL BRACKET

- NW6192-SBL Mill
- NW6192-BK Black
- NW6192-BZ Bronze (Special Order)
- NW6192-WH White (Special Order)
- ▶ 1" x 1" Small Base
- ▶ Aluminum die cast
- ▶ 100 each per case @ 18lbs

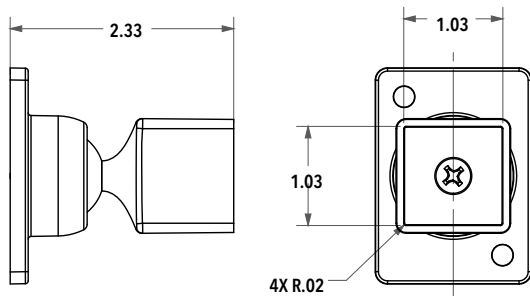

### SWIVEL BALL BRACKET

- NW6266-SBL Mill
- NW6266-BK Black
- NW6266-BZ Bronze (Special Order)
- NW6266-WH White (Special Order)
- ▶ 1" x 1 1/8" Small Base
- ▶ Aluminum die cast
- ▶ 100 each per case @ 19lbs

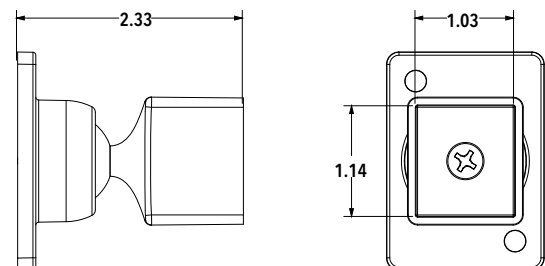



# ORNAMENTAL WALL MOUNT BRACKETS

## 1" X 1 1/2"

### SINGLE FLANGE WALL MOUNT BRACKET

- NW217-SBL Mill  
 NW217-26 Black (Special Order)  
 NW217-36 Bronze (Special Order)  
 NW217-56 White (Special Order)
- ▶ 1" x 1 1/2"
  - ▶ Aluminum die cast
  - ▶ 240 each per case @ 44lbs



### SWIVEL BALL BRACKET

- NW6239-SBL Mill  
 NW6239-BK Black (Special Order)  
 NW6239-BZ Bronze (Special Order)  
 NW6239-WH White (Special Order)
- ▶ 1" x 1 1/2" Small Base
  - ▶ Aluminum die cast
  - ▶ 100 per case @ 21lbs
  - ▶ All Special Order



Turn and angle in any direction

### RECTANGULAR DUAL FLANGE WALL MOUNT BRACKET

- NW6167-MI Mill
- ▶ 1" x 1 1/2"
  - ▶ Aluminum die cast
  - ▶ 250 per case @ 38lbs

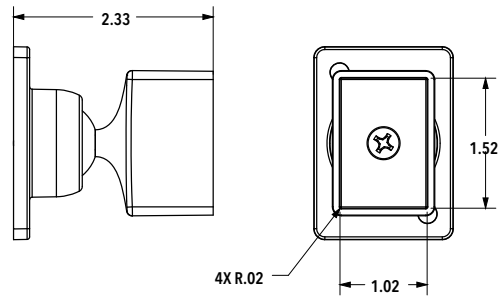

## 1 1/8" X 1 1/8"

### ADJUSTABLE DUAL FLANGE WALL MOUNT BRACKET

- NW6075V-BK Black  
 NW6075V-BZ Bronze  
 NW6075V-WH White  
 NW6075V-SBL Mill (Special Order)
- ▶ 1 1/8" x 1 1/8"
  - ▶ Aluminum die cast
  - ▶ Adjustable for angle or rake rails
  - ▶ 100 each per case @ 29lbs



### ADJUSTABLE DUAL FLANGE WALL MOUNT BRACKET

- NW6075-SBL Mill  
 NW6075-BK Black  
 NW6075-BZ Bronze  
 NW6075-WH White
- ▶ 1 1/8" x 1 1/8"
  - ▶ Aluminum die cast
  - ▶ Adjustable for angle or rake rails
  - ▶ 100 each per case @ 20lbs

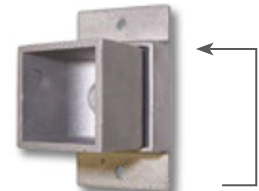

Cup swivels in bracket to desired angle

## 1 1/4" X 1 1/4"

### SINGLE FLANGE WALL MOUNT BRACKET

- NW211A-MI Mill
- ▶ 1 1/4" x 1 1/4"
  - ▶ Aluminum die cast
  - ▶ 300 each per case @ 30lbs



### SWIVEL BALL BRACKET

- NW6220-SBL Mill  
 NW6220-BK Black  
 NW6220-BZ Bronze (Special Order)  
 NW6220-WH White (Special Order)
- ▶ 1 1/4" x 1 1/4" Small Base
  - ▶ Aluminum die cast
  - ▶ 300 each per case @ 30lbs

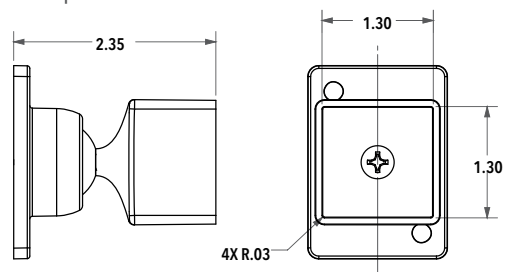

All Painted Swivel Ball and Adjustable Brackets are Assembled

# ORNAMENTAL WALL MOUNT BRACKETS

1 1/4" X 1 1/2"

## SWIVEL BALL BRACKET

NW6216-SBL Mill  
 NW6216-BK Black  
 NW6216-BZ Bronze  
 NW6216-WH White

- ▶ 1 1/4" x 1 1/2" Small Base
- ▶ Aluminum die cast
- ▶ 100 each per case @ 21lbs
- ▶ All Special Order



Turn and angle in any direction

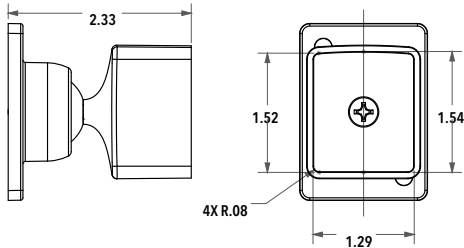

1 3/8" X 1 3/8"

## ADJUSTABLE DUAL FLANGE WALL MOUNT BRACKET

NW6075A-SBL Mill  
 NW6075A-BK Black (Special Order)  
 NW6075A-BZ Bronze (Special Order)  
 NW6075A-WH White (Special Order)

- ▶ 1 3/8" x 1 3/8"
- ▶ Aluminum die cast
- ▶ Adjustable for angle or rake rails
- ▶ 100 each per case @ 29lbs



Note: Any brackets used in railing applications should be tested within the railing system to any applicable codes.

1 1/2" X 1 1/2"

## SINGLE FLANGE WALL MOUNT BRACKET

NW292-SBL Mill  
 ▶ 1 1/2" x 1 1/2"  
 ▶ Aluminum die cast  
 ▶ 100 each per case @ 30lbs



All Painted Swivel Ball and Adjustable Brackets are Assembled



Bronze now comes in 2 shades. BZ or (-36) is standard dark bronze. BZ2 is a lighter bronze. Check for availability or minimum order quantity.

## SWIVEL BALL BRACKET

NW6240-SBL Mill  
 NW6240-BK Black (Special Order)  
 NW6240-BZ Bronze (Special Order)  
 NW6240-WH White (Special Order)

- ▶ 1 1/2" x 1 1/2" large base
- ▶ Aluminum die cast
- ▶ 100 each per case @ 35lbs

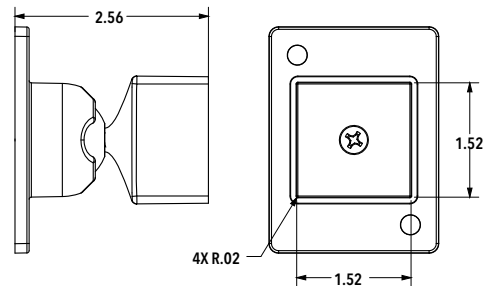

## Bread Loaf Rail Brackets

NW6258-SBL Mill  
 NW6258-BK Black  
 NW6258-BZ Bronze (Special Order)  
 NW6258-BZ2 Lighter Bronze (Special Order)  
 NW6258-WH White (Special Order)

- ▶ Aluminum die cast
- ▶ 100 each per case @ 44lbs

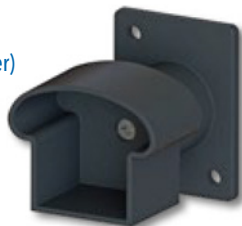

NW6259-SBL Mill  
 NW6259-BK Black  
 NW6259-BZ Bronze (Special Order)  
 NW6259-BZ2 Lighter Bronze (Special Order)  
 NW6259-WH White (Special Order)

- ▶ 150 each per case @ 25lbs

BLACK FINISH



MILL FINISH

# ORNAMENTAL WALL MOUNT BRACKETS AND HAND RAIL BRACKETS

1 5/8" X 1 5/8"

## SQUARE DUAL FLANGE WALL MOUNT BRACKET

NW243-SBL Mill

- ▶ 1 5/8" x 1 5/8"
- ▶ Aluminum die cast
- ▶ 240 each per case @ 47lbs



## SWIVEL BALL BRACKET

NW6217-SBL Mill (Special Order)

NW6217-BK Black

NW6217-BZ Bronze (Special Order)

NW6217-WH White (Special Order)

- ▶ 1 5/8" x 1 5/8" large base
- ▶ Aluminum die cast
- ▶ 100 each per case @ 22lbs



## ADJUSTABLE DUAL FLANGE WALL MOUNT BRACKET

NW279-SBL Mill Cup

NW279BP-SBL Mill Base Plate

- ▶ 1 5/8" x 1 5/8"
- ▶ Aluminum die cast
- ▶ Adjustable for angle or rake rails
- ▶ 100 each per case @ 29lbs

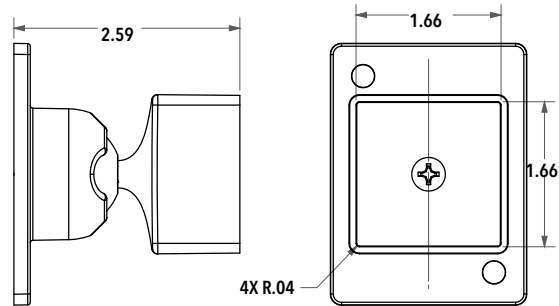

The 1 5/8" X 1 5/8" Wall Mount Bracket needs both the Cup and Base Plate and must be ordered together

1 3/4" X 1 3/4"

## STRAIGHT WALL MOUNT BRACKET

NW6247-SBL Mill

NW6247-BK Black (Special Order)

NW6247-BZ Bronze (Special Order)

NW6247-WH White (Special Order)

- ▶ 1 3/4" x 1 3/4"
- ▶ Aluminum die cast
- ▶ 150 each per case @ 34lbs



## SWIVEL BALL BRACKET

NW6235-SBL Mill

NW6235-BK Black (Special Order)

NW6235-BZ Bronze (Special Order)

NW6235-WH White (Special Order)

- ▶ 1 3/4" x 1 3/4" large base
- ▶ Aluminum die cast
- ▶ 100 each per case @ 43lbs



## STRAIGHT HAND RAIL BRACKET

NW6265-SBL Mill (Special Order)

NW6265-BK Black (Special Order)

NW6265-BZ Bronze (Special Order)

NW6265-WH White (Special Order)

- ▶ Aluminum die cast
- ▶ 200 each per case @ 27lbs

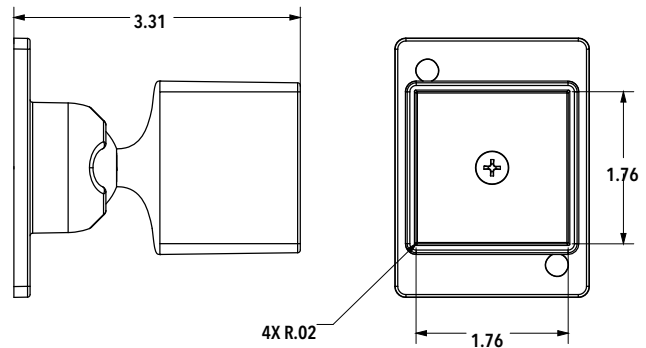

All Painted Swivel Ball and Adjustable Brackets are Assembled

# ORNAMENTAL WALL MOUNT AND RAIL BRACKETS

## Deco Brackets

### RESIDENTIAL STRAIGHT WALL BRACKET

NW6226-SBL Mill  
 NW6226-BK Black  
 NW6226-BZ Bronze (Special Order)  
 NW6226-WH White (Special Order)

- ▶ Aluminum die cast
- ▶ 350 each per case @ 19lbs

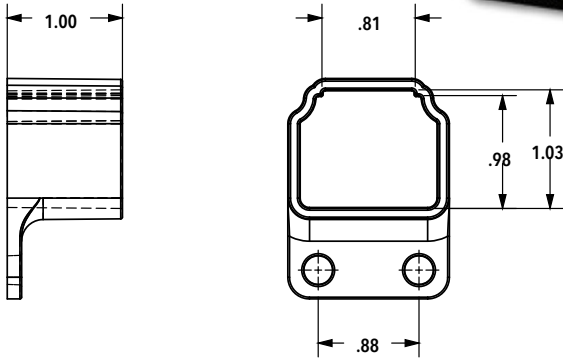

### COMMERCIAL STRAIGHT WALL BRACKET

NW6227-SBL Mill  
 NW6227-BK Black  
 NW6227-BZ Bronze (Special Order)  
 NW6227-WH White (Special Order)

- ▶ Aluminum die cast
- ▶ 350 each per case @ 23lbs

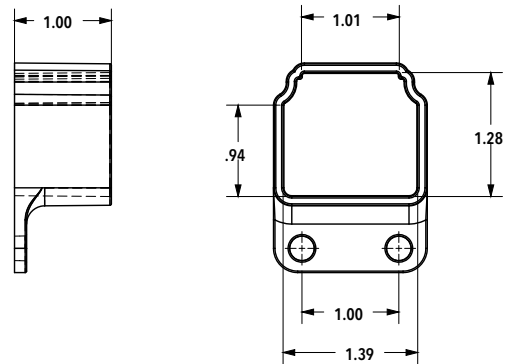

### RESIDENTIAL SWIVEL BALL BRACKET

NW6195-SBL Mill  
 NW6195-BK Black  
 NW6195-BZ Bronze (Special Order)  
 NW6195-WH White (Special Order)

- ▶ Small Base
- ▶ Aluminum die cast
- ▶ 100 each per case @ 19lbs

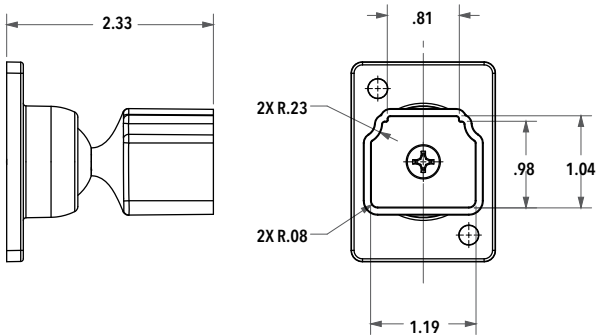

### COMMERCIAL SWIVEL BALL BRACKET

NW6228-SBL Mill  
 NW6228-BK Black  
 NW6228-BZ Bronze (Special Order)  
 NW6228-WH White (Special Order)

- ▶ Small Base
- ▶ Aluminum die cast
- ▶ 100 each per case @ 16lbs

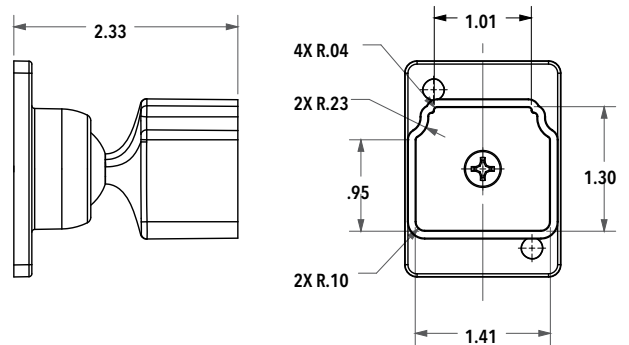

### NEW! INDUSTRIAL STRAIGHT WALL BRACKET

NW6309-SBL Mill  
 NW6309-BK Black  
 NW6309-BZ Bronze (Special Order)  
 NW6309-WH White (Special Order)

- ▶ Aluminum die cast
- ▶ 250 each per case @ 27lbs

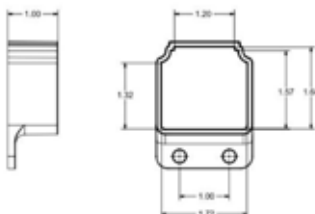

### NEW! INDUSTRIAL SWIVEL BALL BRACKET

NW6308-SBL Mill  
 NW6308-BK Black  
 NW6308-BZ Bronze (Special Order)  
 NW6308-WH White (Special Order)

- ▶ Aluminum die cast
- ▶ 100 each per case @ 34lbs

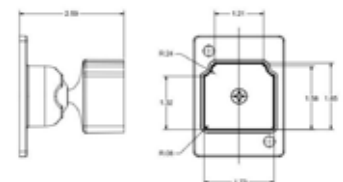



# ORNAMENTAL WALL MOUNT BRACKETS AND END CAPS

1" X 2"

## RECTANGULAR DUAL FLANGE RAIL MOUNT BRACKET

NW6233-SBL Mill

- ▶ Accommodates a 1" x 2" rail
- ▶ Dual Flange Wall Mount
- ▶ Aluminum die cast
- ▶ 100 each per case @13lbs



## RECTANGULAR SINGLE FLANGE RAIL MOUNT BRACKET

NW6241-SBL Mill

- ▶ Accommodates a 1" x 2" rail
- ▶ Aluminum die cast
- ▶ Top/bottom mounting holes
- ▶ 200 each per case @ 24lbs



## FLAT WALL MOUNT BRACKET

WI-SL1X2

- ▶ 168 per case @ 30lbs.



2-1/8" X 1-1/8"

## FLAT WALL MOUNT BRACKET

WI-SL2X1-B

- ▶ 216 per case @ 41lbs



## FLAT WALL MOUNT BRACKET

WI-SL2X1-S

- ▶ 200 per case @ 32lbs.



1" X 1 5/8"

## ROUND SINGLE FLANGE WALL MOUNT BRACKET

NW6238-SBL Mill

- ▶ 1" x 1 5/8"
- ▶ Aluminum die cast
- ▶ 300 each per case @ 52lbs



## Patio Railing Brackets

### 'V' FLANGE WALL MOUNT BRACKET

NW272-36 (WI-SMB-36) Bronze

NW272-56 (WI-SMB-56) White

NW272-76 (WI-SMB-M) Mill

- ▶ Accepts both bottom channel & snap plate
- ▶ 1" x 1 13/16" opening
- ▶ Aluminum die cast
- ▶ 280 each per case @ 42lbs



## RECTANGULAR DUAL FLANGE WALL Mount Bracket

NW268-36 Bronze

NW268-56 White

NW268-76 Mill

- ▶ Accommodates a 1" X 1 7/8 "rail
- ▶ Aluminum die cast



- ▶ Accepts both bottom channel and snap plate
- ▶ 168 each per case @ 50lbs

## MUSHROOM SINGLE FLANGE MOUNT BRACKET

NW270-36 Bronze

NW270-56 White

NW270-76 Mill

- ▶ Accommodates a 1 5/8" x 2 5/8" rail O.D.
- ▶ Aluminum die cast
- ▶ 160 each per case @ 47lbs



## MUSHROOM RAILING END CAP

NW269-36 Bronze

NW269-56 White

NW269-76 Mill

- ▶ Accommodates a 1 5/8" x 2 1/4" rail I.D.
- ▶ Aluminum die cast
- ▶ 300 each per case @ 47lbs



## ROUND TOP SINGLE FLANGE MOUNT BRACKET

NW271-26 Black

NW271-36 Bronze

NW271-56 White

NW271-76 Mill

- ▶ Accommodates a 1 5/8" x 2" rail O.D.
- ▶ Aluminum die cast
- ▶ 210 each per case @ 43lbs



## ROUND TOP RAILING END CAP

NW267-36 Bronze

NW267-56 White

NW267-76 Mill

- ▶ Accommodates a 1 1/4" x 1 3/4" rail I.D.
- ▶ Aluminum die cast
- ▶ 300 each per case @ 40lbs



## FLOOR MOUNT ALUMINUM DIE CAST

NW273-36 (WI-HR-4A-BZ) Bronze

NW273-56 (WI-HR-4A-WH) White

NW273-76 Mill

- ▶ Accommodates a 1 7/8" x 1 1/2" post
- ▶ Profile height: 1 3/4"
- ▶ Flange: 4 3/8" x 4 3/8"
- ▶ 45 each per case @ 41lbs



# ORNAMENTAL FLOOR MOUNTS AND COVER PLATES

## FLOOR MOUNTS

All Floor Mount Brackets are Aluminum Die Cast

- NW302-MI (WI-2X2B) Mill
- NW302H-MI Mill with hole for set screw
- NW302-26 (WI-2X2B-BK) Black
- NW302-36 (WI-2X2B-BZ) Bronze
- NW302-56 (WI-2X2B-WH) White
  - ▶ Accommodates a 2" x 2" post
  - ▶ Profile height: 1 3/4"
  - ▶ Flange: 4 3/8" x 4 3/8"
  - ▶ 50 each per case @ 44lbs



- NW6187H-MI Mill with hole for set screw
- NW6187H-BK Black with hole for set screw
- NW6187H-BZ Bronze with hole for set screw (Special Order)
- NW6187H-WH White with hole for set screw (Special Order)
  - ▶ Accommodates a 2 1/2" x 2 1/2" post
  - ▶ Profile height: 1 3/4"
  - ▶ Flange: 4 7/8" x 4 7/8"
  - ▶ 40 each per case @ 44lbs

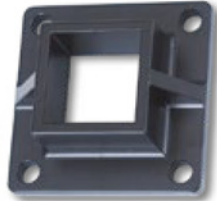

- NW6173H-MI Mill with hole for set screw
- NW6173H-BK Black with hole for set screw
- NW6173H-BZ Bronze with hole for set screw (Special Order)
- NW6173H-WH White with hole for set screw (Special Order)
  - ▶ Accommodates a 3" x 3" post
  - ▶ Profile height: 1 3/4"
  - ▶ Flange: 5 3/8" x 5 3/8"
  - ▶ 20 each per case @ 38lbs

## PREMIUM FLOOR MOUNT BRACKETS

- NW6248-SBL Mill
- NW6248-BK Black (Special Order)
- NW6248-BZ Bronze (Special Order)
- NW6248-WH White (Special Order)
  - ▶ Accommodates 2" posts
  - ▶ Aluminum die cast
  - ▶ OD: 5" x 1.72" high
  - ▶ 50 each per case @ 60lbs



- NW6249-SBL Mill (Special Order)
- NW6249-BK Black (Special Order)
- NW6249-BZ Bronze (Special Order)
- NW6249-WH White (Special Order)
  - ▶ Accommodates 2 1/2" posts
  - ▶ Aluminum die cast
  - ▶ OD: 5" x 1.72" high
  - ▶ 50 each per case @ 58lbs



- NW6248/49PLUGBK Black
  - ▶ Bolt Hole Cover for Premium Floor Mounts
  - ▶ Each - Order amount needed



## ONE PIECE COVER PLATE

- NW6197-SBL Mill
- NW6197-BK Black
- NW6197-BZ Bronze (Special Order)
- NW6197-WH White (Special Order)
  - ▶ Accommodates a 2" x 2" post
  - ▶ Profile height: 1 7/8"
  - ▶ OD: 4 3/4" x 4 3/4"
  - ▶ Fits Over NW302
  - ▶ 50 each per case @ 25lbs



- NW6198-SBL Mill
- NW6198-BK Black
- NW6198-BZ Bronze (Special Order)
- NW6198-WH White (Special Order)
  - ▶ Accommodates a 2 1/2" x 2 1/2" post
  - ▶ Profile height: 1 7/8"
  - ▶ OD: 5 1/4" x 5 1/4"
  - ▶ Fits Over NW6187
  - ▶ 50 each per case @ 29lbs

- NW6190-MI Mill
- NW6190-BK Black
- NW6190-BZ Bronze (Special Order)
- NW6190-WH White (Special Order)
  - ▶ Accommodates a 3" x 3" post
  - ▶ Profile height: 1 7/8"
  - ▶ OD: 5 21/32" x 5 21/32"
  - ▶ Fits Over NW6173
  - ▶ 50 each per case @ 32lbs

## TWO PIECE COVER PLATE

- NW6243-SBL Mill
- NW6243-BK (WI-2PCS-PB-2X2B) Black
- NW6243-BZ Bronze (Special Order)
- NW6243-WH White (Special Order)
  - ▶ Accommodates a 2" x 2" post
  - ▶ Profile height: 1 7/8"
  - ▶ Flange: 4 3/4" x 4 3/4"
  - ▶ Fits Over NW302
  - ▶ 50 each per case @ 24lbs



- NW6288-SBL Mill
- NW6288-BK Black
- NW6288-BZ Bronze (Special Order)
- NW6288-WH White (Special Order)
  - ▶ Accommodates a 3" x 3" post

- NW6269-SBL Mill
- NW6269-BK Black
- NW6269-BZ Bronze (Special Order)
- NW6269-WH White (Special Order)
  - ▶ Accommodates a 2 1/2" x 2 1/2" post
  - ▶ Profile height: 1.9"
  - ▶ Flange: 5 1/5" x 5 1/5"
  - ▶ Fits Over NW6187
  - ▶ 50 each per case @ 29lbs

## TWO PIECE "CORE" COVER PLATE

Hides Concrete Residue

- NW6257-SBL Mill
- NW6257-BK Black
- NW6257-BZ Bronze (Special Order)
- NW6257-WH White (Special Order)
  - ▶ Accommodates a 2" x 2" post
  - ▶ Profile height: 7/8"
  - ▶ OD: 4 5/8" x 4 5/8"
  - ▶ 100 each per case @ 22lbs



- NW6263-SBL Mill
- NW6263-BK Black
- NW6263-BZ Bronze (Special Order)
- NW6263-WH White (Special Order)
  - ▶ Accommodates a 2 1/2" x 2 1/2" post
  - ▶ Profile height: 7/8"
  - ▶ OD: 5 1/8" x 5 1/8"
  - ▶ 100 each per case @ 20lbs

# KNUCKLES, O-RINGS AND KEYLESS LOCKS

## NEW! ALUMINUM INDUSTRIAL DOUBLE 'O' RING

- NW6334-SBL Mill (Special Order)  
 NW6334-BK Black  
 NW6334-BZ Bronze (Special Order)
- ▶ Used with 1" Picket system
  - ▶ 3.96" Outer Diameter
  - ▶ 3.34" Inner Diameter
  - ▶ 50 each per case @ 35lbs



## ALUMINUM DECORATIVE SINGLE 'O' RING

- NW237A-MI Mill
- ▶ Used with 3/4" picket system
  - ▶ 4" Outer Diameter
  - ▶ 3 1/4" Inner Diameter
  - ▶ 120 each per case @ 40lbs



## ALUMINUM DECORATIVE SINGLE 'O' RING USE WITH 5/8" PICKET SYSTEM (SPECIAL ORDER)

NW237MC Mill

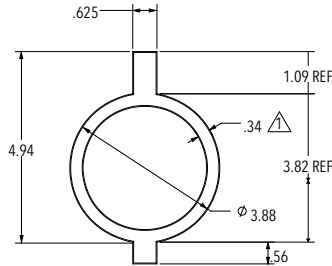

## ALUMINUM DECORATIVE DOUBLE 'O' RING

- NW237DBL-MI Mill  
 NW237DBL-26 Black  
 NW237DBL-36 Bronze
- ▶ Used with 3/4" picket system
  - ▶ Spacing between two rings is .770"
  - ▶ 3 7/16" Outer Diameter
  - ▶ 2 7/8" Inner Diameter
  - ▶ 50 each per case @ 24lbs



## 3" ALUMINUM RING

- WI-RING-3
- ▶ 100 per case



## 3-7/8" ALUMINUM RING

- WI-RING-WD
- ▶ 100 per case



## 5/8" ALUMINUM QUAD RING

- WI-4RING
- ▶ 45 per case @ 40lbs



## NEW! ALUMINUM DECORATIVE SCROLL

- NW241-SBL Mill (USS1) (Special Order)
- ▶ Used with 5/8" picket system
  - ▶ Fits .600 Profile
  - ▶ 3 5/8"(H) x 3 3/4"(W) x 5/8"(D)
  - ▶ 160 each per case @ 42lb



- NW241J-SBL Mill
- ▶ Fits .625 Profile

- NW6326-SBL Mill
- ▶ Used with 3/4" picket system
  - ▶ Fits .75 Profile
  - ▶ 200 each per case @ 48lbs

## KNUCKLES

- NW6262-SBL Mill - Accommodates 3/4" Picket  
 NW6261-SBL Mill - Accommodates 1" Picket
- ▶ Aluminum die cast
  - ▶ Standard part for welding
  - ▶ Add hole for screw mount
- NW6262: 50 each per case @ 13lbs  
 NW6261: 50 each per case @ 12lbs

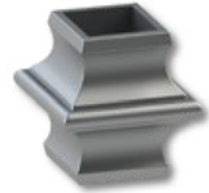

## KEYLESS LOCKS

### Two Sided Keypad

- 2835ABDC - Antique Brass  
 2835BBDC - Bright Brass  
 2835BCDC - Bright Chrome  
 2835JBMGDC - Jet Black Marine Grade  
 2835OILDC - Oil Rubbed Bronze  
 2835SCMGDC - Satin Chrome Marine Grade  
 2835SNDC - Satin Nickel  
 2835WHDC - White



### 1 Side Keypad & 1 Side Blank

- 2835AB - Antique Brass  
 2835BB - Bright Brass  
 2835BC - Bright Chrome  
 2835JBMG - Jet Black Marine Grade  
 2835OIL - Oil Rubbed Bronze  
 2835SCMG - Satin Chrome Marine Grade  
 2835SN - Satin Nickel  
 2835WH - White



### Lockboxes for 2835

- GB2500 Steel  
 GB2500-AL Aluminum
- ▶ Screws included



## SEE PAGE 13 FOR KEYLESS LOCK ADAPTER



### One Sided

- NW-285-P-SC Satin Chrome
- ▶ For use with NW-PB1100-SC Panic Bar



# LOCK BOXES, GATE HANDLES AND BUMPERS, DROP RODS

## MORTISE LOCKSET BOX

NW214-MI Mill (WI-LB-S)

- ▶ Box is 3 3/8"(H) x 4 7/16"(W) x 2"(D)
- ▶ Welded into gate profile to accommodate traditional mortise lockset
- ▶ 50 each per case @ 29lbs



## DOUBLE HOLE LOCK BOX

WI-LB-D

- ▶ 35 each per case



## NYLON GATE BUMPER

NW6186-SD-BK Black

NW6186-SD-WH White

- ▶ Made with durable glass-filled nylon with UV inhibitors
- ▶ Flanges are each 2"(W) x 1.75"(D) for durable attachment
- ▶ Overall height is 4.5"
- ▶ Stainless steel screws included
- ▶ 50 each per case @ 22lbs
- ▶ Also available in quantities of 10



Handle Bumper  
Also Available



## NYLON GATE HANDLES

NW314S-BK w/S.S. screws Black

NW314S-WH w/S.S. screws White

NW314-BK (WI-NGH) w/o screws Black

NW314-WH (WI-NGH-W) w/o screws White

- ▶ Made with durable glass-filled nylon with UV inhibitors
- ▶ Flanges are each 1.5"(W) x 1.25"(D) for durable attachment
- ▶ Overall height is 5" and handle is .75" deep
- ▶ Very comfortable and easy to grasp
- ▶ 50 each per case @ 8lbs



## STAINLESS STEEL GATE HANDLE

NW6184-BK Black

NW6184-WH White

- ▶ 2-Sided Attachment
- ▶ Modern Design
- ▶ Stainless steel screws included
- ▶ 100 each per case @ 35 lbs



## STAINLESS STEEL GATE BUMPER

NW6237-BK

- ▶ Slim line Design
- ▶ 2-Sided Attachment
- ▶ Stainless Steel Screws included
- ▶ 50 each per case @ 7lbs



## HEAVY DUTY STAINLESS STEEL DROP RODS

- 24"** NW38305-24SS Mill  
NW38305-24SSB Black  
NW38305-24SSW White  
▶ 20 each per case @ 39lbs

- 36"** NW38305-36SSB Black  
NW38305-36SSW White (Special Order)  
▶ 10 each per case @ 23lbs

- 48"** NW38305-48SSB Black  
NW38305-48SSW White (Special Order)  
▶ 10 each per case @ 40lbs  
▶ 5/8" diameter  
▶ Screws included  
▶ Dual guides  
▶ Pad-lockable  
▶ Retention-ears for theft prevention



## STAINLESS STEEL KEY LOCKING DROP RODS

- 18"** NW38305KL-18SSB Black  
NW38305KL-18SSW White  
▶ 10 each per case @ 21lbs

- 24"** NW38305KL-24SSB Black  
NW38305KL-24SSW White  
▶ 10 each per case @ 23lbs

- 36"** NW38305KL-36SSB Black  
NW38305KL-36SSW White  
▶ 10 each per case @ 36lbs

- 48"** NW38305KL-48SSB Black  
NW38305KL-48SSW White  
▶ 10 each per case @ 45lbs  
▶ Add the appeal of a key lock to your drop rod  
▶ Anti-theft protection  
▶ The handle & brackets are made of low-maintenance, glass filled nylon  
▶ The rods are 300 series stainless steel  
▶ Available with Black or White brackets  
▶ 2-sided bracket attachment  
▶ Stainless steel screws included

Designed with multiple "set" points for desired height when in the "up" position



All Lockable Drop Rods  
Can Be Keyed Alike



## ARBOR COLLAR

NW6275-SBL

- ▶ 1.5"-2.5" Arbor Collar
- ▶ 50 each per case @ 42lbs

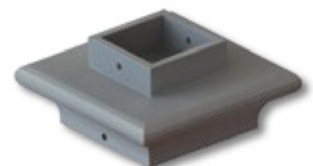



# DROP RODS, GUIDE ROLLERS, HYDRAULIC GATE CLOSERS

## ALUMINUM DROP RODS

NW38305A1-24BK

- ▶ Colors are special order
- ▶ Fits gates frames 1" or larger
- ▶ 24" height
- ▶ Rust resistant and cost effective
- ▶ Light to handle, easy to install
- ▶ Stainless steel screws included
- ▶ 20 each per case @ 23 lbs

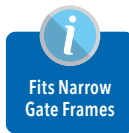

Comes with a holder for "up position"



## COMMERCIAL DROP RODS

**24"** NW6270-24BK Black  
NW6270-24HDG Hot Dip Galvanized

- ▶ 10 each per case @ 46lbs

**36"** NW6270-36BK Black  
NW6270-36HDG Hot Dip Galvanized

- ▶ 10 each per case @ 55lbs

**48"** NW6270-48BK Black  
NW6270-48HDG Hot Dip Galvanized

- ▶ 5 each per case @ 36lbs
- ▶ Heavy duty 1" O.D. drop rod
- ▶ Zinc plated, powder coated steel
- ▶ Through bolt design
- ▶ Can be used on vinyl, wood, aluminum or steel gates



## COMMERCIAL PAD LOCKABLE DROP RODS

**24"** NW6270L-24BK Black  
NW6270L-24HDG Hot Dip Galvanized

- ▶ 10 each per case @ 46lbs

**36"** NW6270L-36BK Black  
NW6270L-36HDG Hot Dip Galvanized

- ▶ 10 each per case @ 55lbs

**48"** NW6270L-48BK Black  
NW6270L-48HDG Hot Dip Galvanized

- ▶ 5 each per case @ 36lbs



## GUIDE ROLLERS

NW6271-BK Black  
NW6271-WH White

- ▶ Plastic roller
- ▶ Used for Vinyl and Ornamental gates
- ▶ Zinc plated bracket for welding
- ▶ Bracket is 6.2" in height
- ▶ 15 each per case @ 38lbs



WI-RGR-C  
▶ Cover for WI-RGR  
▶ 200/Case



WI-RGR  
▶ 3" Nylon Guide Roller  
▶ No cover  
▶ 40/Case



## GUIDE ROLLERS

WI-RGR-BKT  
▶ 3" Rubber Guide roller with bracket  
▶ 8/Case



## "V" GROOVE TRACK WHEELS

ROLL2BV - 2"  
ROLL3BV - 3"  
▶ 25 each per case @ 44lbs  
ROLL4BV - 4"  
▶ "V" Groove, Zinc plated steel  
▶ 16 each per case @ 50lbs  
▶ Attached bracket included



## V-TRACK

WI-EGT-016-10H  
▶ Aluminum Extrusion  
▶ 10' V-track with alternating holes every 18"  
▶ Please contact customer service for bundle quantities

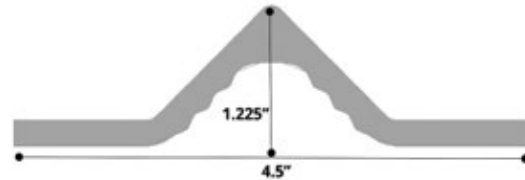

## HYDRAULIC GATE CLOSERS

GC2-BK Black  
GC2-WH White  
▶ Works with gates up to 125 lbs  
▶ Works with gates widths up to 54"  
▶ Adjustable closing speed and adjustable latching speed  
▶ 90° hold open feature  
▶ Maximum opening of 90°  
▶ Powder coated steel  
▶ 12 each per case @ 30 lbs



GC1-BK Black  
▶ Works with gates up to 150 lbs  
▶ Works with gates widths up to 54"  
▶ Adjustable closing speed  
▶ 90° hold open feature  
▶ Powder coated steel  
▶ 8 each per case @ 43 lbs

Other Colors Available



# HYDRAULIC GATE CLOSERS, TROLLEYS AND PEDESTALS

## PATENTED NEW! SHOTGUN® GATE CLOSER

### Controlled Closing Power to Avoid Gate Slamming

SHOTGUN-BK Black  
SHOTGUN-SC Satin Chrome

- ▶ One SKU closes any gate up to 250 lbs\*
- ▶ Anti-slam technology
- ▶ Adjustable closing speed
- ▶ No oil therefore no leaks
- ▶ 10 per case @67lbs

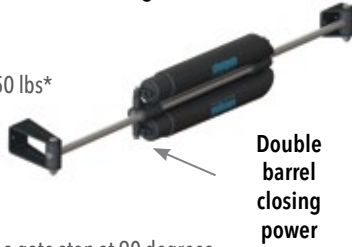

Double  
barrel  
closing  
power

\*Tested on a 6' high, 6' wide. Needs a gate stop at 90 degrees

## TROLLEY FOR CANTILEVER GATES

NW-TROLLEY4WA

- ▶ 4W: 6/Case @ 29lbs



NW-TROLLEY8WA

- ▶ 8W: 4Case @ 31lbs

## 4 WHEEL TROLLEY

WI-TROLLEY-M4S

- ▶ Cast Steel body
- ▶ Horizontal Wheels O.D. 2.125"
- ▶ Vertical Wheels O.D. 2.045"
- ▶ 12/Case



## 8 WHEEL TROLLEY

WI-WTS10-1

- ▶ Machined Steel body
- ▶ Horizontal Wheels O.D. 2.125"
- ▶ Vertical Wheels O.D. 2.045"
- ▶ 8/Case



WI-TROLLEY-8P

- ▶ Cast Aluminum
- ▶ 8/Case

## TROLLEY BRACKETS

NW-TRLLBKT-R-HD

- ▶ 4" Round, Heavy Duty Gage
- ▶ 6/Case @ 45lbs



NW-TRLLBKT-S-HD

- ▶ 4" Square, Heavy Duty Gage
- ▶ 6/Case @ 45lbs



## TROLLEY BRACKETS

NW-TRLLBKT-RD300-STL - 3"

NW-TRLLBKT-RD-STL - 4"

NW-TRLLBKT-RD658-STL - 6-5/8"

- ▶ Round, Heavy Duty Gage
- ▶ 4/Case @ 40lbs



NW-TRLLBKT-SQ300-STL - 3"

NW-TRLLBKT-SQ-STL - 4"

NW-TRLLBKT-SQ600-STL - 6"

- ▶ Square, Heavy Duty Gage
- ▶ 4/Case @ 40lbs



WI-HANG-4R- 4"

- ▶ Round
- ▶ 8/Case

WI-HANG-4S - 4"

- ▶ Square
- ▶ 8/Case

WI-HANG-6S - 6"

- ▶ Square
- ▶ 4/Case



## GOOSE NECK PEDESTALS

WI-ACA-1 42"

WI-ACA-2 48"

- ▶ Access Control Arm w/base
- ▶ Pad Mountable
- ▶ 1 piece per case @ 17lbs

WI-ACA-1-B 54"

WI-ACA-72-B 72"

- ▶ Direct Burial
- ▶ 1 piece per case @ 20lbs

WI-GNC-DUAL-72

- ▶ Dual Arm Pedestal
- ▶ 42" and 72" Pedestal
- ▶ 1 piece per case 42lbs.

WI-ACA-HD

- ▶ Heavy Duty Pedestal
- ▶ 1 piece per case





# ***NATIONWIDE INDUSTRIES™***







## THE FENCE PRO'S CHOICE

### For Fence and Railing Hardware

Nationwide Industries has the largest, in-stock selection of fence and gate hardware for fence professionals. Our products are guaranteed to last, easy to install, and ship in 24-hours so you can focus on doing what you do best.



# ***NATIONWIDE*** ***INDUSTRIES***<sup>™</sup>

Phone: (813) 988-2628 • Fax (866) 988-3465  
[www.nationwideindustries.com](http://www.nationwideindustries.com) • [info@nationwideindustries.com](mailto:info@nationwideindustries.com)

